



π PYROTEC
PACKMARK

Together, We Grow

CODING, LABELLING & SOFTWARE CATALOGUE

INDEX

01 CODING

Industries
IP Ratings
Types of Machines

Entry Level Equipment
Intermediate Level Equipment
Expert Level Equipment

02 PRIMARY CODERS

Anser U2 Mobile-S
Anser U2 Pro-S Inkjet
Anser X1

Markem-Imaje Continuous Inkjet Printers:

9018
9029
9330
9410
9450
9450 E
9450 S
9040, 9040 S & 9040 IP65
9040 Contrast
9750

Thermal Transfer Overprinters:

SmartDate X30
SmartDate X45
SmartDate X65
SmartDate X65-128

Laser:

SmartLase C150 / C350
SmartLase C350 HD & LHD
The Smartlase C600
Lightjet Vector
Fiber Laser Coder F200
SmartLase F250

03 SECONDARY CODERS & LABELLERS

Thermal Inkjet Printer:

Anser Mobile ONE
Anser U2 Smart Inkjet
Anser U2 Smart ONE

Valvejet Printer:

4500
4700

2200 Series - Print and Apply Labelling
- 2200 eTouch S
5800 - Large Character Piezo
5940 G - Touch Dry Inkjet Coder

04 TERTIARY LABELLERS

2200 Pallet - Print and Apply Labelling
CimPak - Print and Apply Labelling

05 LABELLERS

Label Dispensers
Manual Hand Labeller - MHL
Bottle-Matic - Cylindrical Labeller
PackWrap - Labelling and Coding
Self-Adhesive Labeller - ELDH

Altech Labellers:

ALstep E & S
ALritma
ALritma Xtra
ALline
ALmatic

Harlands Labellers:

ALpharma
Accraply

06 CONSUMABLES

07 ACCESSORIES

08 SERVICES AND SPARES

09 PACKWORX (Custom Engineering)

10 SOFTWARE Pyrotec PackLink CoLOS v6.xx

11 FINANCE

12 CONTACT DETAILS

CODING & LABELLING

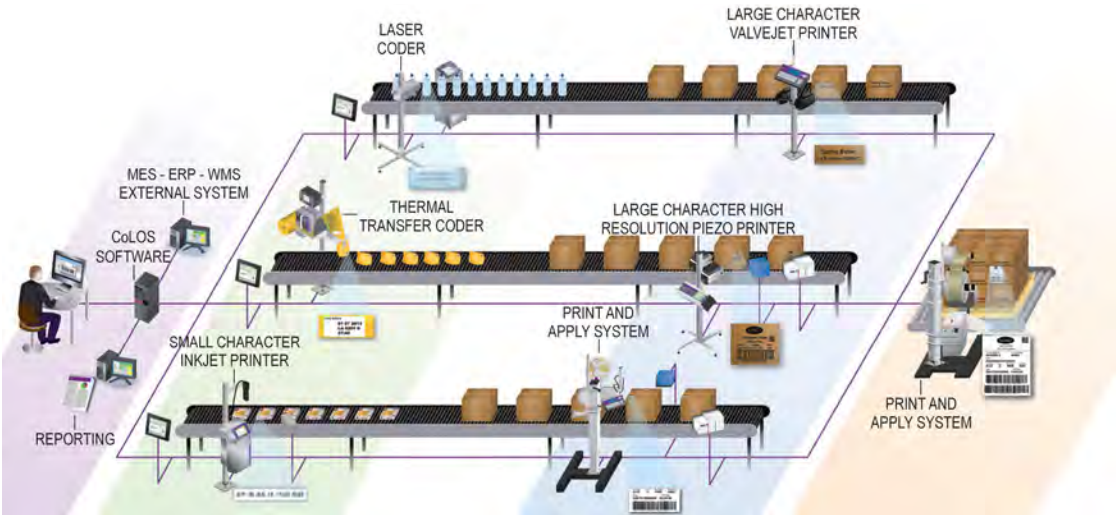

Primary coding

- Small character inkjet: 9000 Series
- Thermal transfer: SmartDate Series
- Laser: 7000 Series
- TIJ/Anser

Secondary coding

- Print and apply labelling: 2200 Series and CimJet
- Large character high-resolution piezo: 5000 Series
- Large character valvejet: 4500 and 4700

Tertiary coding

- Print and apply labelling: 2200 Pallet and CimPak

Labelling

Primary (product labelling)

- Secondary (case/box labelling)
- Tertiary (pallet labelling)

Software solutions

- Pyrotec PackLink software is a fully-integrated customised product tracking system that increases line visibility while improving efficiency by tracking waste, labour and resources, and limiting downtime by enabling critical decisions to be made on the fly.
- Packaged coding software: CoLOS Create, CoLOS Create Professional and CoLOS Enterprise.
- Traceability software: CoLOS Insite, CoLOS Pallet Track, CoLOS Coding Integrity and CoLOS Line Traceability.

01 Coding

2003088080 WF7031
16:46 BestBy 03/2023

OUR CUSTOMERS ARE IN THESE INDUSTRIES

Pyrotec PackMark has built its market knowledge and consultative approach by implementing a wide array of well-targeted coding and labelling solutions for numerous industries. Pyrotec PackMark can adapt its offer to your specific needs. Pyrotec PackMark delivers the right insights, technologies and support to help your packaging operations overcome increasing competitive pressure, more complex operations and demanding retailer and regulatory mandates.

Food

MARKETS: Dairy products, fresh fruits and vegetables, fresh meat and poultry products, dehydrated foods, biscuits and cakes, chocolate and sugar confectionery.

CODES: Best before dates, batch numbers, ingredients, logos, barcodes, 2D codes and QR codes.

LABELLERS: Manual, semi-automatic, fully-automatic, print & apply.

SUBSTRATES: Flexible packaging, rigid plastic, paper-based container and liquid carton.

MARKET NEEDS: High-quality marking, robustness for demanding environments, compliance with legal requirements, reduction of packaging inventory and printing of promotional codes.

Beverage

MARKETS: Still soft drinks, fruit juice and fruit drinks, wine and spirits, mineral water, liquid milk, beer and ciders.

CODES: Best before dates and batch numbers.

LABELLERS: Manual, semi-automatic, fully-automatic, print & apply.

SUBSTRATES: Rigid plastic, metal, glass and liquid carton.

MARKET NEEDS: High-speed printing, robustness for demanding environments and printing of promotional codes.



Cosmetics, toiletries and pharmaceuticals

CODES: Best before dates, batch numbers, logos, barcodes, 2D codes and serialisation.

LABELLERS: Manual, semi-automatic, fully-automatic, print & apply.

SUBSTRATES: Flexible packaging, rigid plastic, paper-based container and glass.

MARKET NEEDS: Compliance with legal requirements, brand protection, high-quality marking and product decoration.

Electrical and electronics

MARKETS: Electrical and electronic components, light bulbs and tubes, radio, television and other brown goods, white goods, CD and DVD disks, smart cards and phone cards.

CODES: Logos and requirement specifications.

LABELLERS: Manual, semi-automatic, fully-automatic, print & apply.

SUBSTRATES: Plastic coating, ceramics, alloy coated or painted metal, rigid plastic, tin-plated, printed circuit board laminate material and chips.

MARKET NEEDS: High-quality marking, compliance with legal requirements and brand protection.

Cables, tubes and profiles

CODES: Logos, requirement specifications and specific coding wire and cable options.

LABELLERS: Manual, semi-automatic, fully-automatic, print & apply.

SUBSTRATES: Wide range of polymers (PE, PP, PA, PUR, halogen-free, etc).

MARKET NEEDS: High-quality printing, robustness for demanding environments, high-speed printing and reduction of packaging inventory.

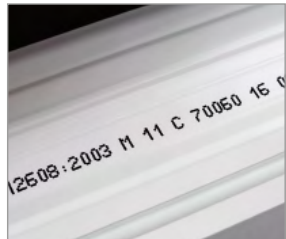
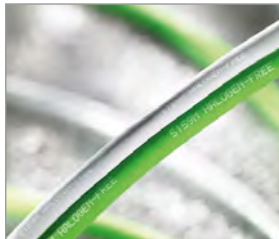
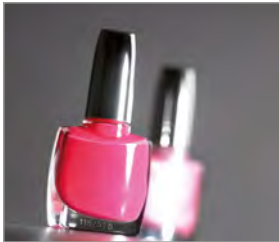

THE RIGHT SOLUTION FOR EVERY INDUSTRY

Small Character Inkjet

BENEFITS: 9000 Series are full-featured printers designed for demanding manufacturing environments, general purpose as well as very specific applications like high contrast and high-performance marking.

CONSUMABLES: Designed to print on all types of substrates from standard to specific applications (food grade, sterilisation, UV cure, egg coding, etc.); alcohol-based, water-based, ketone-free and MEK-free inks available; wide variety of colours.

SUBSTRATES: Plastics, glass, metal, cardboard and directly onto food.

MARKETS: Food, beverage, cosmetics, toiletries, electrical, electronics, cables, tubes and profiles.

Thermal Transfer

BENEFITS: SmartDate Series delivers high-quality printing on flexible packaging films, foils and labels for continuous and intermittent operations, at the fastest print and acceleration or deceleration speeds. It includes multiple ribbon saving features.

CONSUMABLES: A wide range of approved high-quality thermal transfer ribbons for both flat and near edge printheads.

SUBSTRATES: Flexible packaging like flow wrappers, bags, tray seals, pouches, sachets, vacuum packs or labels.

MARKETS: Food and mechanical engineering.

Laser

BENEFITS: 7000 Series coders are well-suited for high-speed printing in large coding areas and tough production environments, especially those requiring multi-head scribing. They offer impeccable high contrast code and are capable of covering coding and scoring applications simultaneously.

CONSUMABLES: Dust filters for fume extractors.

SUBSTRATES: Plastics, glass, painted metal and cardboard.

MARKETS: Food, beverage, cosmetics, toiletries and pharmaceuticals.

Large Character Valvejet

BENEFITS: 4500 and 4700 incorporates innovative simplicity and flexibility. Characterised by their compact size, 4500 Plus is perfect for one side case coding while 4700 is ideal for multi-side case coding up to 3 shifts.

CONSUMABLES: Available in alcohol, ethyl acetate and water based in many colours.

SUBSTRATES: Corrugated cases.

Large character high-resolution piezo

BENEFITS: Solvent-free and environmentally friendly Touch Dry® Hot Melt inks of 5200, 5400 and 5800 coders print codes and logos. Codes never bleed or fade, dry on contact and are 100% readable.

CONSUMABLES: Touch Dry® technology is solid at room temperature while liquid inks are available in alcohol, ethyl acetate and water based in a large range of colours.

SUBSTRATES: Corrugate cases, trays and wrapping films.

Print and apply labelling

BENEFITS: 2200 Series builds on a proven concept that provides reliability, efficiency and ease of use. It gives you a wide range of interchangeable applicators (Tamp, Wipe, Blow, Tamp Blow and Corner Wrap), optimised operational intervention and an unparalleled application rate.

CONSUMABLES: A wide range of approved high-quality thermal transfer ribbons for both flat and near edge printheads. Our labels and ribbons guarantee print quality and long printhead life. Our combo box ensures line efficiency by reducing downtime.

SUBSTRATES: Corrugated cases and wrapping films for pallet.



IP RATINGS



Data Sheet

IP Ratings

The IP rating system provides a means of classifying the degrees of protection from dust, water and impact afforded by electrical equipment and enclosures.

The system is recognised in most European countries and is set out in BS EN 60529; 1992 Degrees of protection provided by enclosures (IP code).

FIRST NUMBER Protection against solid objects		SECOND NUMBER Protection against liquids	
IP	TESTS	IP	TESTS
0	no protection.	0	no protection.
1	protected against solid objects over 50mm. eg. accidental touch by hands.	1	protected against vertically falling drops of water.
2	protected against solid objects over 12mm. eg. fingers.	2	protected against direct sprays of water up to 15° from the vertical.
3	protected against solid objects over 2.5mm (tools + wires).	3	protected against sprays to 60° from the vertical.
4	protected against solid objects over 1mm (tools, wires + small wires).	4	protected against water sprayed from all directions - limited ingress permitted.
5	protected against dust - limited ingress (no harmful deposit).	5	protected against low pressure jets of water from all directions - limited ingress permitted
6	totally protected against dust.	6	protected against strong jets of water, eg. for use on shipdecks - limited ingress permitted.
		7	protected against the effects of temporary immersion between 15cm and 1m. Duration of test 30 minutes.
		8	protected against long periods of immersion under pressure.

Note: When an IP rating is included in the RS Catalogue, certain points should be taken into consideration as to its interpretation:

1. Although an enclosure has a high IP rating, the equipment being used in conjunction with it may reduce this (eg. through mounted components, accessories and methods of cable entry).
2. An IP rating may be quoted with regard to the maximum protection from the front of the actuator and by means of sealing around the mounting hole.

This rating may not apply to the rear of the component.

The following products are available from RS with IP ratings. Please refer to current RS Catalogue for full details:

ABS sealed boxes
Appliance connectors
Cable glands
Cam switch enclosures
Camera housings
Camsafe switch
Diecast boxes
DIN rail enclosures and mounting boxes DOL starters
Elapsed time metres
Electrically operated bolt
Emergency lighting
Emergency stop buttons
Equipment cases
Flexible conduit
Floodlighting
Flush mounting enclosures
Fuseholders
General purpose tungsten lighting
General purpose wall mounting enclosure guard switches
GRP enclosures
Hazardous area enclosures
Heavy-duty equipment cases
Impulse counters
Industrial foot switch

Industrial key switches
Industrial latching switches
Industrial lever switches
Industrial microswitches
Industrial push-buttons
Industrial push-button stations
Industrial start/stop switches
Industrial switch enclosures
Industrial wall mounting enclosures
Inline RCD
Intruder detectors
Keypad switches
Light sensitive switches
Light switches
Limit switches
Local isolators
Manual motor starters
Moulded enclosures
Panel mounting counters
Panel mounting tachometers
Panel switches
Pliable conduit
Polycarbonate wall boxes
Polyester enclosures
Programmable 7-day time switch Proximity switches
Rear mounting enclosures
Rechargeable handlamp
Rotary cam switches
Rotating mirror beacons
Sealed limit switches
Security lighting
Single path photo relay systems
Single phase soft starters
Stainless steel wall boxes
Sub miniature limit switches
Surface mounting enclosures
Switch fuses
Time switches
Universal guard switch
Wall mounting enclosures and housings
Wall mounting RCCB/MCB enclosures Wall mounting RCCB/MCB socket outlet Weatherproof thermostats





The information provided in RS technical literature is believed to be accurate and reliable, however, RS Components assumes no responsibility for inaccuracies or omissions, or for the use of this information. All use of such information shall be entirely at the user's own risk. No responsibility is assumed by RS Components for any infringements of patent or other rights of third parties, which may result from its use. Specifications shown in RS Components' technical literature are subject to change without notice.

ENTRY LEVEL CODERS, LABELLERS & SOFTWARE

PackMark is Pyrotec's machinery division that offers a comprehensive range of labelling, coding, print-and-apply labelling equipment and consumables. We supply an exclusive range of the very latest hardware from international industry leaders, including Markem-Imaje, ALTech, Accrply Europe LtdAnser.

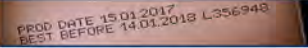
ENTRY LEVEL EQUIPMENT IS PERFECT FOR:

Start-up companies | Total running costs | 2 - 3 lines of print | Slow printing | Labelling

Entry Level: Primary Coding		
CIJ Continuous Inkjet Coder	TTO Thermal Transfer Over printer	Laser
		
9018	SmartDate X30	SmartLase C340
		
Entry Level: Secondary Coding		
DOD (Drop On Demand)	TIJ	Labeller
		
4500	ANSER	BottleMatic
		
Labeller	Labeller	Labeller
		
ELDH	MHL - Metal Manual Hand Labeller	ALstep E
Software		
<p>CoLOS® Base satisfies all design and management requirements for all your Pyrotec PackMark printers.</p>		

CAPE TOWN Tel +27 (0) 21 787 9600
 JOHANNESBURG Tel +27 (0) 11 611 1821
 DURBAN Tel +27 (0) 31 700 2338
 Gqeberha Tel +27 (0) 41 487 0601
 EAST LONDON Tel +27 (0) 66 275 6884

Website www.pyrotec.co.za
 Pyrotechnical Marketing (PTY) Ltd
 Reg. No. 1969/003546/07

Together, We Grow



SABS
 ISO 9001

INTERMEDIATE LEVEL CODERS, LABELLERS & SOFTWARE

PackMark is Pyrotec's machinery division that offers a comprehensive range of labelling, coding, print-and-apply labelling equipment and consumables. We supply an exclusive range of the very latest hardware from international industry leaders, including Markem-Imaje, ALTech, Accrappy Europe Ltd, Anser.

INTERMEDIATE LEVEL EQUIPMENT IS PERFECT FOR:
 Mid-sized companies | Medium speed printing | 3 to 4 lines of printing | Labelling

Intermediate Level: Primary Coding						
TU (Thermal Inkjet Coder)	CIJ (Continuous Inkjet Coder)	CIJ (Continuous Inkjet Coder)	TTO (Thermal Transfer Overprinter)	Laser	Laser	
ANSER U2 Pro-S	9029	9410	SmartDate x45	SmartLase C150	SmartLase C350	
Intermediate Level: Secondary Coding						
Print & Apply	DOD (Drop On Demand)	Piezo	Piezo	Labeller	Labeller	Labeller
2200	4700	5940	5800	ALstep S	Alritma S	Albelt
Intermediate Level: Tertiary Coding						
Print & Apply			Print & Apply			
2200 Pallet			2200 Wipe			
Software						
<p>CoLOS® Line - CoLOS® satisfies all design and management requirements for all your Pyrotec PackMark printers.</p>			<p>Pyrotec PackLink - Pyrotec PackLink is software that can be customised to suit your production environment. This is achieved by centrally managing a unique base of messages on a secured server, which links to your enterprise database allowing the retrieval of all product information.</p>		<p>Pyrotec PackLink - Pyrotec PackLink is software that can be customised to suit your production environment. This is achieved by centrally managing a unique base of messages on a secured server, which links to your enterprise database allowing the retrieval of all product information.</p>	

CAPE TOWN Tel +27 (0) 21 787 9600
 JOHANNESBURG Tel +27 (0) 11 611 1821
 DURBAN Tel +27 (0) 31 700 2338
 GOEBERHA Tel +27 (0) 41 487 0601
 EAST LONDON Tel +27 (0) 66 275 6884

Website www.pyrotec.co.za
 Pyrotechnical Marketing (PTY) Ltd
 Reg. No. 1969/003546/07

Together, We Grow



SABS

ISO 9001

EXPERT LEVEL CODERS, LABELLERS & SOFTWARE

PackMark is Pyrotec's machinery division that offers a comprehensive range of labelling, coding, print-and-apply labelling equipment and consumables. We supply an exclusive range of the very latest hardware from international industry leaders, including Markem-Imaje, ALTech, Accraply Europe Ltd, Anser.

EXPERT LEVEL EQUIPMENT IS PERFECT FOR:
High-speed applications | Total control



Expert Level: Primary Coding

TU (Thermal Inkjet Coder)	CU (Continuous Inkjet Coder)	CU (Continuous Inkjet Coder)	TTO (Thermal Transfer Overprinter)	TTO (Thermal Transfer Overprinter)	TTO (Thermal Transfer Overprinter)	Laser	Laser
							
ANSER XI	9040	9450 E/S/C	SmartDate x65	SmartDate x65/128	SmartLase C350 HD & HD	Fibre F200	Lightjet Vector
							

Expert Level: Secondary Coding

Piezo	Piezo	Labeller	Labeller	Labeller	Labeller
					
5800	5940	Aline	Accraply	Alritma Xtra	2200

Expert Level: Tertiary Coding

Print & Apply	Print & Apply
	
2200 Pallet	Cimpak

Software

	<p>CoLOS® Factory / OEE (Overall Equipment Efficiency) - CoLOS® 6 networks and operates multiple printers through the factory and provides a powerful data management system.</p>		<p>Pyrotec PackLink - Pyrotec PackLink is software that can be customised to suit your production environment. This is achieved by centrally managing a unique base of messages on a secured server, which links to your enterprise database allowing the retrieval of all product information.</p>
---	--	---	--

CAPE TOWN Tel +27 (0) 21 787 9600
JOHANNESBURG Tel +27 (0) 11 611 1821
DURBAN Tel +27 (0) 31 700 2338
GOEBERHA Tel +27 (0) 41 487 0601
EAST LONDON Tel +27 (0) 66 275 6884

Website www.pyrotec.co.za
Pyrotechnical Marketing (PTY) Ltd
Reg. No. 1969/003546/07

Together, We Grow



SABS
ISO 9001



02

Primary Coders

THERMAL INKJET CODER ANSER U2 MOBILE-S



The world's most compact mobile printer. It's ultraportable, lightweight and easy to operate.

Main benefits

- Ultra Lightweight - The world's lightest mobile printer, weighing only 1kg (2.21lb).
- Full Colour Large LCD Display - 2.8-inch colour LCD with LED backlit screen.
- All IN ONE BOX - One tiny box with all the accessories you will ever need: U2 mobile, remote keypad, two high-capacity rechargeable batteries, battery charger, SD card & SD card reader.
- SD Card Slot Design - Easy software upgrade and date backup 600 dpi (For U2 HD Only).
- Ultraportable - Capable of printing anywhere, at any angle, without ink leakage.
- Plug-n-Print - Ink cartridge design with no maintenance and downtime costs.
- Long-Lasting Battery - 7 hours of continuous printing with more than 200,000 characters.
- 600 dpi (For U2 HD Only) - 2 X the resolution for printing crisp & precise HD barcodes. Now available on both U2 & U2-mobile.
- Remote Keypad - Pocket-size remote keypad with user-friendly operation.
- More Ink Selections - Now you can print onto a variety of substrates using ANSER's new Inkfinity ink family.



**Scan here to
get the digital
brochure!**



Print features

- Display: 2.8" full colour LCD with LED-backlit
- LED Indicators: 5 indicators – Alarm, Ink low, Print, Run, Remote on/off
- Available Languages: English, Japanese, French, German, Spanish, Portuguese, Russian, Korean, Italian, Turkish, Chinese (Traditional & Simplified)
- Operation Menu: Digital Menu Selection (DMS) for easy operation
- Input Device: Pocket-size IR remote keypad
- Plug-n-Print Design: Hewlett-Packard TIJ 2.5 printing technology
- Printable Images: Alphanumeric, logo, date/time, expiry date shift code, counter, lot-box code and barcode
- Printable Lines & Heights: 1, 2, 3, 4 lines. Total line height is limited to 12.7mm (0.5")
Heights: 2.7mm, 3.6mm, 5.5mm, 8mm, 10mm, 12.7mm (0.11", 0.14", 0.22", 0.31", 0.39", 0.5")
- One inch option available
- Print Speed: 57 metres (148 feet)/minute at 400 dpi horizontal resolution
- Message Storage Capacity: Store up to 999 messages with SD card
- Dimension (L/W/H): 212 x 135 x 120 (mm) / 8.3 x 5.3 x 4.7 (inch)
- Weight: 1Kg (2.20Lb) – excludes cartridge and battery

Long-lasting battery

- Rated Capacity: 3,700 mAh
- Standard Voltage: 11.1V
- Input/Output Voltage: 12.6V
- Charging Voltage: 12.6V
- Charging Hours: 2.5 hours
- Charging Temperature Range: 0°C – 45°C (32°F – 113°F)
- Discharging Temperature Range: -10°C – 45°C (14°F – 113°F)
- Dimension (L/W/H): 65 x 51 x 37 (mm) / 2.5 x 2 x 1.5 (inch)
- Weight: 165g (0.36Lb)
- Cycle Life: More than 300 cycles
- Continuous Printing Hours: 7 hours
- Standby Time: 9 hours

Other characteristics

- **Ink Solutions:** A wide range of ink selections for printing on porous, semi-porous and non-porous substrates.
- **Environment:** Operating temperatures range 5°C – 40°C (41°F – 104°F) both flat and near edge printheads. Our labels and ribbons guarantee print quality and long printhead life. Our combo box ensures line efficiency by reducing downtime.

Scan here
to watch
the video!



THERMAL INKJET CODER ANSER U2 PRO-S INKJET



Small yet powerful. The world's first solvent compatible cartridge specially designed for primary package coding applications.

Main benefits

- Comprehensive solvent ink portfolio.
- Wide range of substrates coverage.
- UV ink solution for critical substrates.

Print features

- Display 3.5": Colour LCD with LED backlight
- User Interface: Simple and easy-to-use operating system
- Input Device: Pocket-sized IR remote keypad
- Available Languages: English, Japanese, French, German, Spanish, Portuguese, Russian, Korean, Italian, Turkish, Hungarian, Slovak, Czech, Swedish, Romanian, Polish, Serbian, Bulgarian, Chinese (Traditional & Simplified)
- LED Indicators: Alarm, Ink Low, Print, Run, Remote on/off



**Scan here to
get the digital
brochure!**



Print features

- Print Engine: Hewlett-Packard Thermal Ink Jet Technology
- Print Resolution & Print Speed: 600 x 300 dpi (76.2 m/min) Print quality is dependent on resolution and speed
- Throw Distance: Recommended 6mm from nozzle to surface
- Print Height: Up to 4 lines and 12.7mm (0.5"). Selectable font size from 2.7mm, 3.6mm, 5.5mm, 8mm, 10mm, 12.7mm
- Print Capability: Alphanumeric, logos, date/time, shift code, counter, lot box code
- Barcodes: Code-128, ITF-14(SCC-14), NVE(SSCC-18), EAN-128, PDF417, Data Matrix, QR Code,
- DUN-14, GS1 DataBar, UPCA, UPCE, EAN-13, EAN-8, Codabar, Code 25 Interleaved, Code-39
- Power: AC 100V~240V, 50/60Hz
- Weight: 0.49 kg (1.08 lbs) – Cartridge and brackets not included
- Dimensions: 114 (L) x 76 (W) x 60 (H) mm
- Mounting Orientation: Horizontal or downside
- Message Storage Capacity: Store up to 999 messages
- Operating Temperature: 5°C – 40°C (41°F – 104°F)
- Data Interface: RS-485 & USA

Optional Accessories

- **Encoder:** Provide high print quality on unstable conveyor.
- **Photocell:** Provide more reliable and precise sensing parameter.
- **Alarm Kit:** Alert users in the event of an incident.
- **UV Curing Kit:** Provide stable and reliable curing performance for SUV series ink .

Scan here
to watch
the video!



THERMAL INKJET CODER ANSER X1



ONE inkjet printer controlling TWO production lines simultaneously.

Scratch & damage resistant

Glove operational, yet smartphone-like sensitive touch screen

Cooling fin design

To ensure reliable coding at high temperature environments

Large-Image Coding

2-inch print height



**Scan here to
get the digital
brochure!**



Specifications – Controller

- Maximum number of printheads: 2
- Display 7" Color LCD Capacitive Touchscreen (800x480 px) (Compatible with most medical & industrial gloves)
- Printing Functions Static Data: Text, Logo Dynamic Data: String, Shift, Counter, Production Date, Expiration Date
- Fonts & Size Standard: Arial, Other True Type Fonts can be loaded
- System Language(add input lang.) English, Spanish, German, French, Italian, Traditional Chinese, Simplified Chinese, Japanese, Korean, Russian, Portuguese, Turkish, Hungarian, Slovak, Czech, Swedish, Romanian, Serbain, Bulgarian, Polish
- Dimensions & Weight 291 x 142 x 52mm / 2.12 Kg
- Operating Temp. 0-40 Celsius
- Communication Protocols TCP IP/UDP, Modbus TCP, and ANSER U2 Net protocol
- Power Input AC 100V~240V, 50/60Hz (90Watt)
- I/O Ports - USB 2.0 connector x 2, RS-485 & RS-232 connector x 1, RJ-45 connector x 1, Digital I/O connector (1 IN & 5 OUT pins), Encoder x 1, Photocell x 1
- Barcode Type EAN8, EAN13, EAN14, EAN128, UPCA, UPCE, CODE39, CODE128, ITF14 (SCC-14), NVE18 (SSCC-18), INTER25, CODABAR, PDF417DATAMATRIX, QR CODE, GS1 (DATAMATRIX, DATABAR EXP, DATABAR, QR CODE), D'MATRIX 8x32, DUN14, Aztec Code
- Operating RH. 0%~90%, Non-condensing
- IP Rating: IP66 housing

Specifications – Printhead

- Printing Technology High Resolution Thermal Ink Jet
- Print Height Stitch Print Head: 12.7mm x 2 @ 25.4mm (1.0 inch) or 25.4mm x 2 @ 50mm (1.97 inch), Single Print Head: 12.7mm (0.5 inch) or 25.4mm (1.0 inch)
- Printing Resolution 600 x 600 DPI
- Printing Speed 30m/min @ 600 DPI or 300m/min @ 60 DPI
- Printing Distance 6 mm
- Operating Temp. 0-40 Celsius
- Operating RH. 0% ~ 90%, Non-condensing
- Dimensions & Weight 82 x 30 x 210 mm / 0.46kg
- Printhead Cables Standard: 2M, Optional: 5M, 10M, 15M

Specifications – Consumables

- Bulk Ink Systems:
 - H-A01-BIS is a quick-dry water-based bulk ink solution for printing on glass, 0.5 Inch cartridge, available in black
- Solvent-based Ink Cartridge
 - Black S2 half inch
 - Black ANSER H-S06 Ink Cartridge
 - Yellow and White Inkfinity S1
 - Black I-S01-1 inch
- Water-based Ink Cartridge
 - Red Inkfinity P3 (Water-based)
 - Blue Inkfinity P1 (Water-based)

**Scan here
to watch
the video!**



SMALL CHARACTER INKJET 9018



Engineered to bring you the innovation you deserve with the simplicity you require, the Markem-Imaje 9018 is smart, easy to run and always ready to print.

Thanks to its innovative, all-inclusive M6' ink circuit, expect two years of non-stop production. Easy to change, the M6' can be clicked in and clicked out in less than 6 minutes with no specialised tools required. The new innovative cartridge system and associated ink offer (MEK-free and permanent ink) makes set-up automatic and clean, optimising your operators' time and your overall production uptime.

With its straightforward design, the 9018 is ready to print within minutes of purchase, even in the harshest environments.

Main benefits

- Up to 3 lines of print.
- Print speed up to 3 m/s.
- Creation of logos directly on the operator/machine interface.
- Jet Speed Control guarantees marking quality.
- Automatic selection of fonts, depending on print speed and printhead/object distance.



**Scan here to
get the digital
brochure!**



Print features

- Mono-jet printhead
- G head (printing resolution: 71dpi)
- Up to 3 lines of print
- Print speed: up to 3m/s
- Font height: from 5 to 24 dots
- Character height: from 1.8 to 8.7mm
- Wide choice of characters (Latin, Arabic, Cyrillic, Greek, Japanese, Chinese, Hebrew, Korean etc.)

Options

- RS-232 connectivity
- Printhead pressurisation kit (plant air required)
- Encoder and alarm connectivity
- 3 metre umbilical
- Dust environment filter kit

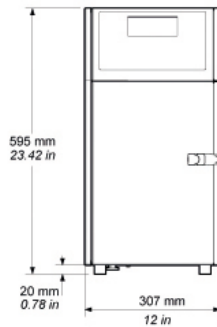
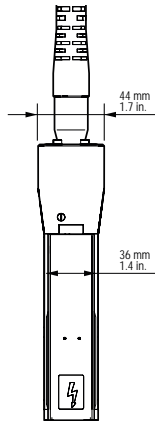
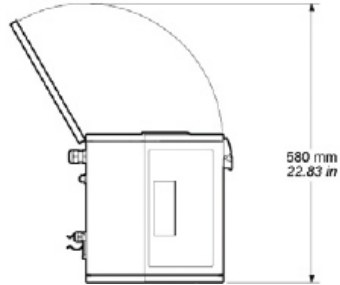

**Scan here
to watch
the video!**



SMALL CHARACTER INKJET 9029



Between manufacturing and selling your products, you have more important things to worry about than ensuring the quality of your code. Engineered to bring you the innovation you deserve with the simplicity you require, the Markem-Imaje 9029 will facilitate daily operations and save you time!

Easy to set up

- Easy to install
- Move it and install it anywhere according to your needs, thanks to its robust IP55 fully stainless steel design
- Easy to design messages
- Quickly create or upload your codes via the newly designed user interface and USB connection
- Easy to run
- Intuitive online guide to manage your coder daily on your own more efficiently



**Scan here to
get the digital
brochure!**



Smart to operate

- The M6: A smart all-in-one ink circuit that runs for 6000 hours*. Optimise your time and change your M6 in less than 6 minutes and on your own. No extra maintenance needed.
- Reduced Total Cost of Ownership. Reduce your additive consumption by 50%** thanks to a latest generation hydraulic system.
- Smart consumable. No set-up required. With its innovative cartridge system design, you'll experience advanced consumable management.
- Smart in use. No import or export issues. Its standard priced MEK-free ink facilitates supply, compliance and safety related issues.

Print features

- Mono-jet printhead
- G head (printing resolution: 71dpi)
- Up to 4 lines of print
- Print speed: up to 4.4m/s
- Font height from 5 to 24 dots
- Character height from 1.8 to 8.7mm
- Wide choice of characters (Latin, Arabic, Cyrillic, Greek, Japanese, Chinese, Hebrew, Korean)

Options

- One and two dimensional barcodes (Datamatrix)
- Ethernet connectivity
- Printhead pressurisation kit (plant air required)
- Autonomous pressurisation kit (no plant air required)
- 3 metre umbilical

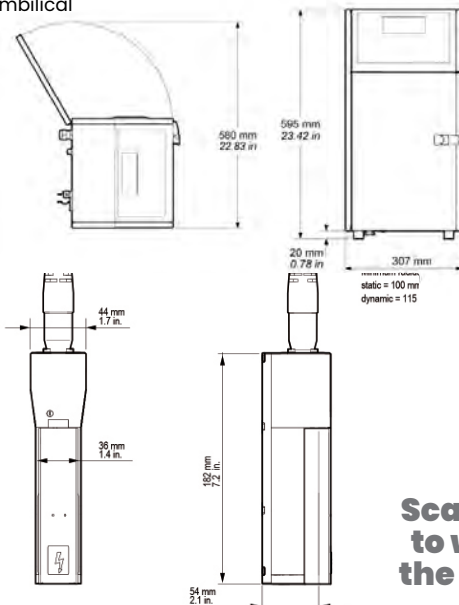

Scan here
to watch
the video!



SMALL CHARACTER INKJET 9330



Designed for low to medium duty applications, the 9330 is a versatile cost-efficient inkjet coder that grows with your company and allows you to print for more than 8000 hours non-stop.*

Easy to operate

Optimize installation time and daily activities thanks to its compact design and user interface.

Cost-efficient

Print non-stop for more than 8,000 hours and lower consumable expenses by up to 50%.

A long term coding solution

Ensure the quality of your codes and benefit from a wide selection of inks for numerous applications.

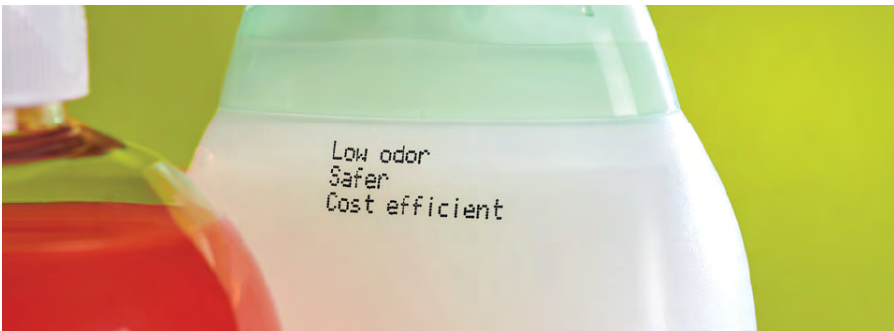

**Scan here to
get the digital
brochure!**



Print features

- Mono-jet printhead
- G head (printing resolution: 71 dpi)
- Up to 4 lines of print
- Print speed: up to 4.4 m/s
- Maximum speed (7 dot high characters):
0.60 m/s (0.36 mm drop pitch for 4 lines)
1.01 m/s (0.36 mm drop pitch for 3 lines)
- Font height from 5 to 24 dots
- Character height: from 1.8 to 8.6 mm
- Wide choice of characters (Latin, Arabic, Cyrillic, Greek, Japanese, Chinese, Hebrew, Korean...)

Options

- Printhead pressurization kit (plant air required)
- Autonomous pressurization kit (no plant air required)

Accessories

- Printer supports: stands (stainless steel or aluminum), table or wall mounting bracket
- Photocell
- Encoder
- Alarm beacon (24 V)

Other characteristics

- Weight: 18.5 kg
- 3-meter flexible umbilical cable
- Stainless steel cabinet
- Dust/humidity protection rating: IP55
- No plant air required
- Operating temperature range: 5° to 40° C, depending on ink used
- Humidity: 0% to 90% non-condensing
- Electrical power supply: 100 - 120 V or 200 - 240 V with automatic switching; frequency 50/60 Hz; power 34 W



Operations

- Message library (up to 1000 messages)
- International operator/machine interface (choice of 31 languages)
- Color touch screen
- Maximum number of characters per second: 2083
- On-screen output: on/off, consumable level indication, current print counter
- On-screen help and maintenance information
- Programmable shut down
- 2 sealed intelligent cartridges, 0.75 liter each
- Quick connect/disconnect of accessories (photocell, encoder, alarm, I/O)
- Connectivity: Ethernet / RS-232

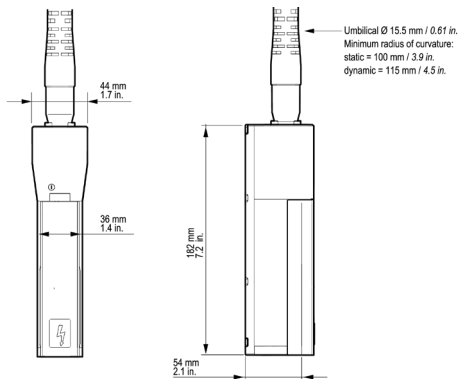
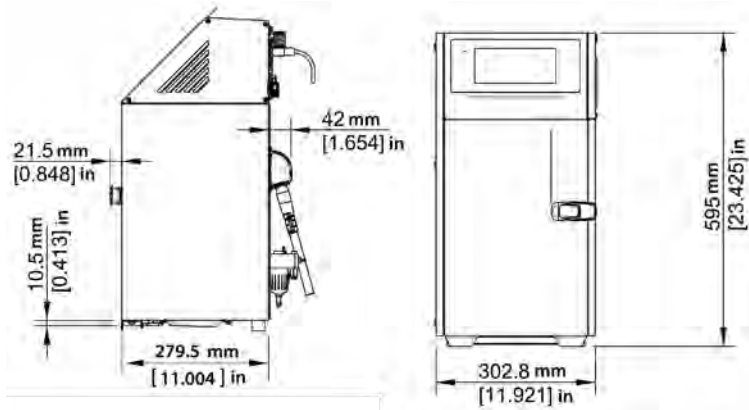

**Scan here
to watch
the video!**



SMALL CHARACTER INKJET 9410

If improving the efficiency of your production process is one of your priorities, the new Markem-Imaje 9410 coder was engineered for you. Designed for full availability, the Markem-Imaje 9410 will match your line speed and secure each of your products with the correct code.



Main benefits

- 99.9% availability
- Up to 20% reduction in consumable use and energy consumption. Optimised waste-related expenses.
- Smart consumable system. No set-up required.
- Clean it with water and industrial detergent and make sure your hygiene standards are met (IP55).
- Promote your brand while achieving your traceability goals (text, logos and 2D barcodes, etc. available in 35 languages).
- Ink references with a high-level of adhesion, contrast and colour where needed as well as anti-counterfeiting solutions and environmentally friendly inks.
- Local language online guiding system will lead you through the steps to ensure your code is exactly what you want it to be.
- Easy access to maintenance and production history.
- Operator access and password management can be configured to your needs, offering more control.
- Create images and network printers with optional CoLOS® software.



**Scan here to
get the digital
brochure!**



Print features

- Mono-jet printhead
- G head (printing resolution: 71 dpi)
- Up to 5 lines of print
- Print speed: up to 4.6 m/s
- Font height from 5 to 32 dots for multiline messages
- Character height: from 1,5 to 11mm
- Wide choice of 1D and 2D barcodes: EA N8/EA N13/UPCA/UPCE barcodes, code 39, Interleaved 2 of 5, Datamatrix and QR code
- Wide choice of characters (Latin, Arabic, Japanese, Cyrillic)

Options

- Printhead pressurisation kit
- Printhead pressurisation kit
- RS-232/422 connectivity, parallel interface, many I/O possibilities to enable remote operation
- Ultra-flexible 6-metre umbilical cable

Printhead

Minimum radius of curvature of the umbilical:

- Static: 100 (3.93 ")
- Dynamic: 150 (5.90 ")

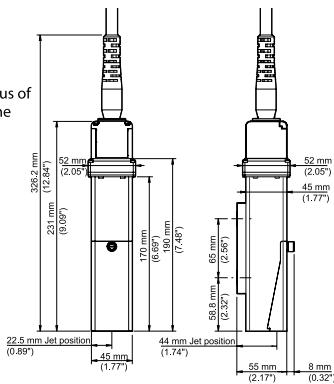

Cabinet

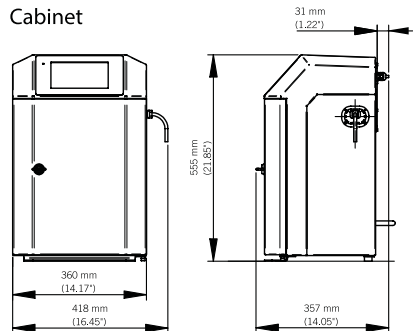

Scan here
to watch
the video!



SMALL CHARACTER INKJET 9450



Improve the efficiency of your production process with the new Markem-Imaje 9450 coder, designed to support your overall equipment efficiency improvement. Designed for full availability, the Markem-Imaje 9450 will match your line speed and secure each of your products with the correct code.

Main benefits

- Maximise your production performance. 99.9% availability rate.
- Up to 20% reduction in consumable use and energy consumption (no need for plant air). Optimises your waste-related expenses.
- Wash it down with pressured water and industrial detergent and make sure your hygiene standards are met (IP56 standard, IP66 optional).
- Automatic cleaning system will ensure jet stability when restarting.
- Smart consumable system. No set-up required.
- Promotional coding and serialisation functions to support your marketing initiatives.
- Ink references with a high level of adhesion, contrast and colour where needed as well as anti-counterfeiting solutions and environmentally friendly inks.
- Easy running cost tracking via smart monitoring system.
- Code integrity is automatically checked via the new embedded Mark & Read vision system.



**Scan here to
get the digital
brochure!**



Print features

- Mono-jet printhead
- G-head (printing resolution: 71 dpi)
- M-head (printing resolution: 115 dpi)
- Up to 5 lines of print
- Print speed: up to 6.6 m/s
- Font height from 5 to 32 dots
- Character height: from 1.2 to 11.2 mm
- Wide choice of 1D and 2D barcodes: EAN 8/EAN 13/UPCA /UPCE barcodes, code 39, Interleaved 2 of 5, Datamatrix, QR code
- Wide choice of characters: Latin, Arabic, Cyrillic, Hebrew, Japanese, Chinese, Korean, etc.

Options

- Promotional coding and Mark and Read
- Ultra-flexible 6 metre umbilical cable
- IP66 protection (requires plant air)
- Ultra-rapid mode for high-speed printing
- Printhead pressurisation kit
- RS-232/422 connectivity, parallel interface, many I/O possibilities to enable remote operation

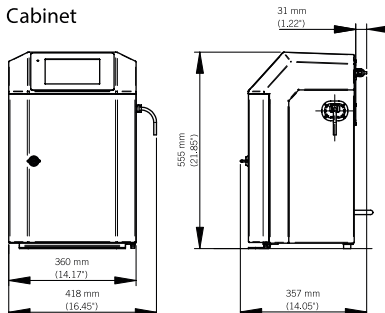
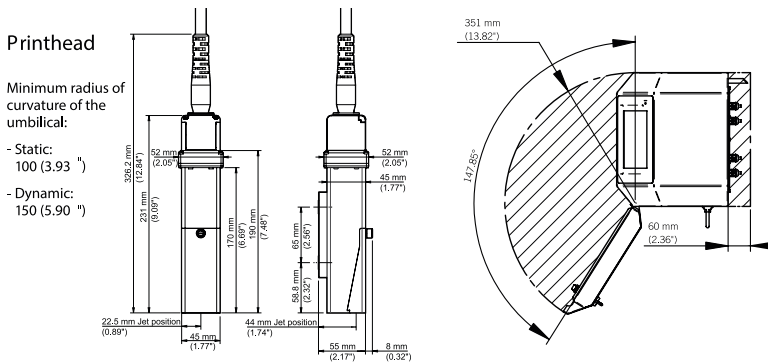

Scan here
to watch
the video!



SMALL CHARACTER INKJET 9450 E



Dedicated to the PIPE, CABLE, TUBE and PROFILE industries, the 9450 E combines a premium ink circuit with a new generation printhead design that will ensure the quality of your codes even on dark substrates with an optimised TCO.

Main benefits

- Up to 3 000 km of cable printing without printhead cleaning.
- 20% faster. Up to 1,000m/min for wire harnessing and optical fibre application.
- Precise, even on the smallest wires.
- Reduced TCO 20% ink savings without compromising on contrast.
- Smart consumable system, no set-up required.
- Precise when using the embedded metering function: 2mm tolerance.
- Additive consumption reduced to 3 ML/H at 20°C.
- Mistake proof user interface even when entering long messages.
- High-performance ink offer dedicated to extruded products providing contrasted durable print, even on difficult substrates like PE and in rough environmental conditions.
- Multiple colours: Black, white, orange, blue, green, red and yellow.



**Scan here to
get the digital
brochure!**



Print features

- Mono-jet printhead
- G head (printing resolution: 71dpi) or M head (printing resolution: 115dpi)
- Up to 5 lines of print
- Print speed: up to 1,000m/min
- Font height: from 5 to 32 dots
- Character height: from 1 to 11mm
- Wide choice of 1D and 2D barcodes: EAN8/EAN13/GS1-128/UPCA/UPCE barcodes, code 39, code 128, Interleaved 2 of 5, Datamatrix, QR code
- Wide choice of characters (Latin, Arabic, Cyrillic, Japanese, Chinese, Hebrew, Korean etc.)

Options

- Printhead pressurisation kit
- 9450 Ec for pigmented ink use
- Ultra-flexible 6 metre umbilical cable
- IP66 protection (requires plant air)
- Enhanced autonomy kit
- RS-232/422 connectivity, parallel interface, many I/O possibilities to enable remote operation

Cabinet

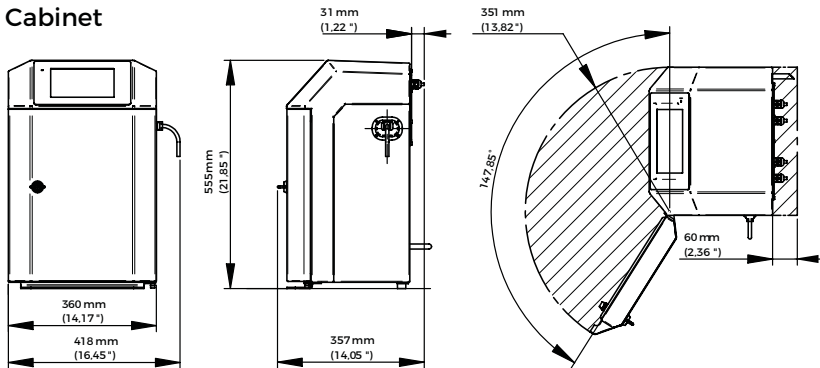

Printhead

Minimum radius of curvature of the umbilical:

- Static: 100 (3.93')
- Dynamic: 150 (5.90')

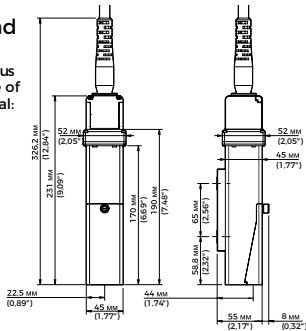

Scan here
to watch
the video!



SMALL CHARACTER INKJET 9450 S



Optimise your TCO and operating expenses by 30%! Dedicated to the BEVERAGE industry, the 9450 S is more than just fast! The 9450 S combines state-of-the-art technology and expertise to ensure your product is coded right on its way out the door to the customer!

Main benefits

- 30% TCO reduction. Optimised additive and energy consumption.
- Smart consumable system reduces errors and requires no set-up.
- Wash it down as much as you need. Your 9450 S will be up and running regardless of intensive cleaning and humid environmental conditions.
- You'll need ONE ink to code all your products! Metal cans, glass and PET bottles, pouches, liquid bricks etc. All coded with the same high-speed 9450 S printer and the same quick-drying, high-adhesion black ink.
- Two-line code on 120 000 containers or packs per hour, all securely coded!
- Promote your brand and carry out your marketing initiatives and campaigns by simply inserting a USB thumb drive.
- Additional high-performance contrast ink offer for dark glass substrates, including for returnable glass.



**Scan here to
get the digital
brochure!**



Print features

- Mono-jet printhead
- G head (printing resolution: 71dpi) or M head (printing resolution: 115dpi)
- Up to 5 lines of print
- Print speed: up to 1,000m/min (9450 ES only)
- Font height: from 5 to 32 dots
- Character height: from 1 to 11.2mm
- Wide choice of 1D and 2D barcodes: EAN8/EAN13/GS1-128/UPCA/UPCE barcodes, code 39, code 128, Interleaved 2 of 5, Datamatrix, QR code
- Wide choice of characters (Latin, Arabic, Cyrillic, Japanese, Chinese, Hebrew, Korean, etc.)

Options

- Promotional coding and Mark & Read
- 9450 Sc for pigmented ink use
- Ultra-flexible 6 metre umbilical cable
- IP66 protection (requires plant air)
- Ultrarapid mode for high-speed printing
- Enhanced autonomy kit
- Printhead pressurisation kit
- RS-232/422 connectivity, parallel interface, many I/O possibilities to enable remote operation

Cabinet

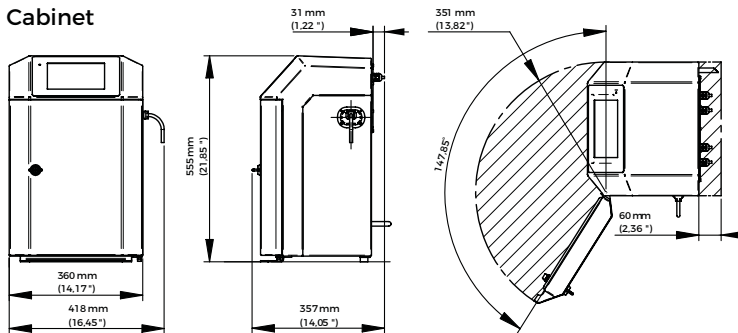

Printhead

Minimum radius of curvature of the umbilical:

- Static: 100 (3.93)
- Dynamic: 150 (5.90)

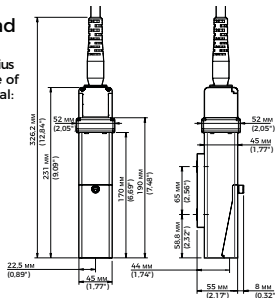

Scan here
to watch
the video!



SMALL CHARACTER INKJET 9040, 9040S AND 9040 IP65



The 9040 is designed to meet customers' most specific requirements. It offers optimum versatility with a wide choice of inks (from general purpose to a very specific one) and a wide choice of options making integration onto most production lines efficient: mono- or twin-jet, single or twin-head systems and three printing resolutions (71, 115 and 178dpi). This printer is ideally positioned for beverage, dairy and industrial applications.

Main benefits

- Up to 8-line printing for best before dates, logos, alphanumeric text, ID and 2D barcodes
- High-speed multiline printing up to 5.5 m/s
- Font heights from five dots to two 24-dot lines
- Character height from 0.7 to 18.2 mm
- Easy change of the consumables without stopping marking operations
- Easy and quick installation of the cabinet on the floor for user-friendly operations
- IP65 cabinet available



**Scan here to
get the digital
brochure!**



Print features

- Mono or bi-jet printhead
- Single or dual printhead systems
- G head (printing resolution: 71 dpi)
- M head (printing resolution: 115 dpi)
- P head (printing resolution: 178 dpi)
- Up to 8 lines of text
- Print speed: up to 5.5 m/s
- Font sizes from five dots to two 24-dot lines
- Character height from 0.7 mm to 18.2 mm
- One and two-dimensional barcodes (Datamatrix)
- Wide selection of characters (Latin, Arabic, Cyrillic, Greek, Japanese, Chinese, Hebrew, Korean, etc.)

Options

- IP65 (requires plant air)
- High-speed (S version)
- Printhead pressurisation kit
- 5 or 8 metre flexible umbilical
- 90° bent umbilical
- 90° bent printhead

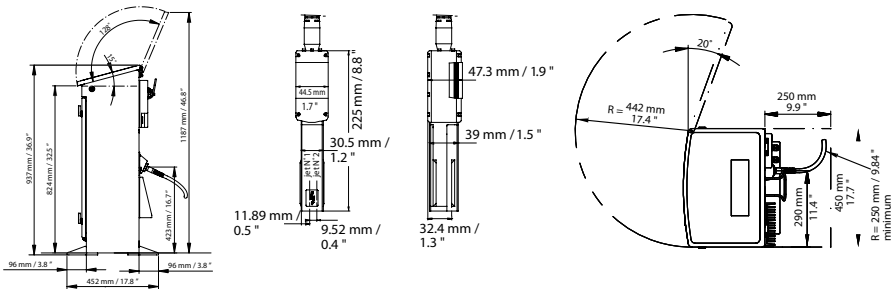

Scan here
to watch
the video!



SMALL CHARACTER INKJET 9040 CONTRAST



The 9040 Contrast is designed for specific applications in automotive, aerospace, cable and extrusion industries. A wide choice of inks and colours are available, including pigmented inks for high contrast printing on dark surfaces. With two printing resolutions (71 and 115 dpi) and mono or twin-jet version, this compact printer makes integration onto most production lines efficient.

Main benefits

- Up to 8 line printing for best before dates, logos, alphanumeric text, 1D and 2D barcodes
- High-speed multiline printing up to 5.5 m/s
- Font heights from 5 dots to two 24-dot lines
- Character height from 1.2 to 18.2 mm
- Easy and quick installation of the cabinet on the floor for user-friendly operations
- Ergonomic design with intuitive user interface featuring shortcuts and direct access to consumables

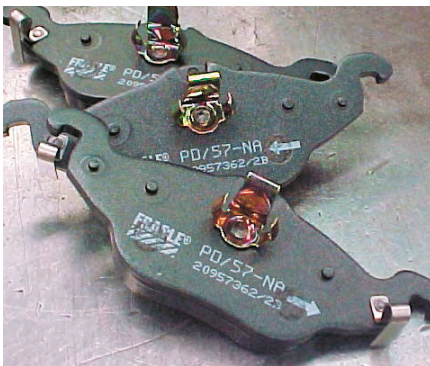

**Scan here to
get the digital
brochure!**



Print features

- Mono or bi-jet printhead.
- G head (printing resolution: 71 dpi)
- M head (printing resolution: 115 dpi)
- Up to 8 lines of text
- Print speed: up to 5.5 m/s
- Font sizes from 5 dots to two 24-dot lines
- Character height from 1.2 mm to 18.2 mm
- One and two-dimensional barcodes (Datamatrix)
- Wide selection of characters (Latin, Arabic, Cyrillic, Greek, Japanese, Chinese, Hebrew, Korean, etc.)

Options

- RS-422 connectivity
- Parallel interface
- Printhead pressurisation kit
- 90° bent umbilical
- 90° bent printhead

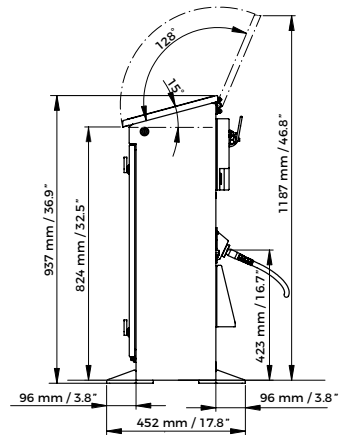
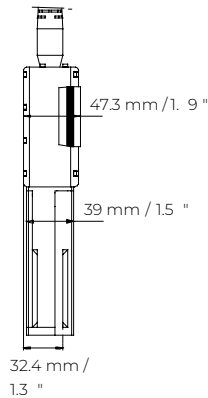
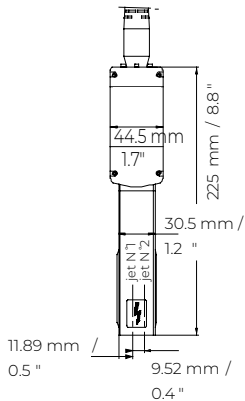
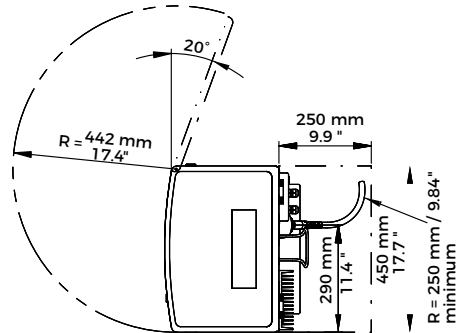

Scan here
to watch
the video!



CONTINUOUS INKJET 9750



Meticulously engineered and qualified by the most modern methods, the 9750's latest enhancements bring you:

- *Technology leaps grounded in time-tested industrial processes for maximized uptime, reduced maintenance*
- *Cutting-edge design with simplified UI and modular components for easy operation, maintenance or repair*
- *Clear, customizable, traceable codes that meet customers' growing demand for supply chain visibility*

Main benefits

- Innovation - Advanced R&D backed by proven industrial processes and method
- Sustainability - More sustainable solutions = Long-term value and lower TCO
- Digitalization - Convenience only a couple clicks away

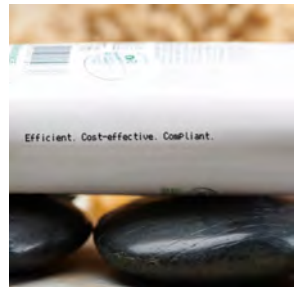

**Scan here to
get the digital
brochure!**



Print features

- Mono-jet printhead
- G head (printing resolution: 71 dpi)
- M head (printing resolution: 15 dpi)
- Up to 5 lines of print
- Print speed: up to 6.6 m/s
- Font height from 5 to 32 dots
- Character height: from 12 to 112 mm
- Wide choice of ID and 2D barcodes: EAN 8/EAN 13/ UPCA /UPCE barcodes, code 39, interleaved 2 of 5, Datamatrix, QRcode, Dotcode
- Wide choice of characters: Latin, Arabic, Cyrillic, Hebrew, Japanese, Chinese, Korean, etc.

Options

- Ultra-flexible 6-meter umbilical cable
- IP66 protection (plant air required)
- TCO option for lower additive consumption: at 20 °C less than 3,5 cc/h for MEK-based ink or less than 2cc/h for MEK-free ink
- Printhead pressurization kit
- Many I/O possibilities including a configurable single point connector (24 pins)

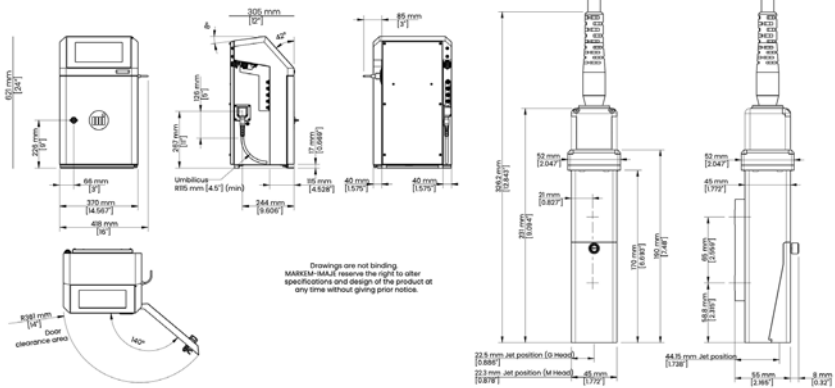

Scan here
to watch
the video!



THERMAL TRANSFER SMARTDATE X30



SmartDate X30 is a robust one-box solution that can be easily installed on your line or integrated by OEMs. It is the ideal coder for low to medium speed production lines printing on flexible film.

Main benefits

- Extremely compact in size (20 cm x 17 cm x 18 cm), it can easily be integrated into your production line and integrated by OEMs.
- No need for plant air to install. In addition to reducing costs, print quality will remain constant through the years.
- Automatic set-up; no human intervention required.
- Dead-dot detection system to eliminate faulty codes.
- Choose the right ribbon type and get up to 15%* more codes per roll.
- Select the right accessories according to your need and budget.
- Simple, robust design, proven in packaging facilities worldwide, delivers consistent results you can rely on.
- Unrivalled 12-month printhead warranty or 40 km*.
- Print speed: 50 to 600 mm/s.



**Scan here to
get the digital
brochure!**



Print features

- **Print speed:**
 - Continuous: 50 to 600 mm/s
 - Intermittent: 100 to 250 mm/s
- **Print area:**
 - Intermittent: 32 mm x 40 mm
 - Continuous: 32 mm x 50 mm
- **Printer features:**
 - Automatic printhead set-up
 - Dead-dot detection
 - Average gap between prints: 0.5 mm
 - Automatic shift codes and serial numbers
 - Multiple variable user input fields with alphanumeric texts
- **Ribbon saving mode:**
 - Radial ribbon saving
 - Interlaced mode
- **Printer specifications:**
 - True Type font support, including non-Roman characters and symbols.
 - Printing of real time clock, dates and auto-updating best before dates, barcodes including; Han Xin, QR/GSI, RSS

Other characteristics

- **Supplies:**
 - Variety of thermal transfer ribbons: SmartDate Xceed, SmartDate Xtra and SmartDate Xpert
 - Ribbon widths: 22 mm and 33 mm
 - Maximum ribbon length: up to 700 m
- **Printer weight:**
 - Intermittent: 5.5 kg
 - Continuous: 5.0 kg
- **Electrical power supply:** ~ 110 – 230 Vac (+/- 10%) 50 – 60 Hz
- SmartDate X30 without power supply requires 24 VDC
- No air supply required
- **Operating temperature range:** 0 to 40 °C
- **Humidity:** 10% to 90% non-condensing

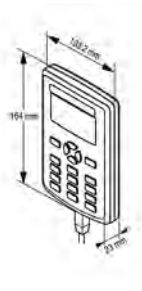
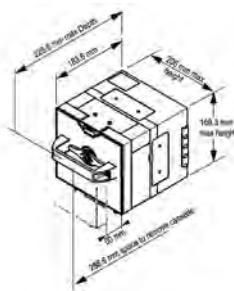

Scan here
to watch
the video!



THERMAL TRANSFER SMARTDATE X45



The SmartDate X45 represents a transparent, advanced coding solution including long-term cost control, planet conscious design, greater uptime and increased performance on the line.

Main benefits

- New standard 1100 m ribbon reduces changeovers and improves cost per print.
- Patented ribbon saving features help to minimise ribbon waste.
- Best industry 12-month standard warranty.
- Excellent availability ratio of up to 99.6% without assistance due to new standard 1100 m ribbon.
- Print speeds up to 600 mm/s.
- High-quality 300 dpi resolution.
- Up to 50% reduction in power consumption.
- Up to 20% less ribbon waste with new standard ribbon design.



**Scan here to
get the digital
brochure!**



Print features

- **Print speed:**

- Intermittent: up to 600 mm/s
- Continuous: 30 to 600 mm/s

- **Print area:**

- Intermittent: 32 mm or 53 mm x 75 mm
- Continuous: 32 mm or 53 mm x 250 mm

- **Print features:**

- Automatic printhead setup
- Detect: Dead-dot detection
- Quick change printhead
- Intermittent or continuous printing
- Easily change from left to right hand with no additional parts
- Gap between prints: 0.5 mm
- Automatic shift codes and serial numbers
- Multiple variable user input fields with alphanumeric texts
- High-pack-rate mode

- **Ribbon-saving mode:** Radial ribbon save, Interlaced mode, Radial mode 1, Radial mode 2, Radial interlaced, Whitespace, Radial whitespace, Step advance

- **Print specifications:** Full TrueType font support, including non-Roman characters and symbols. Printing of real-time clock, dates and autoupdating best before dates, barcodes: ITF, Code 39, Code 128, EAN 128, EAN 8, EAN 13, UPC A, UPC E, RSS linear, PDF 417, ID Matrix, QR and Composite RSS barcodes support.

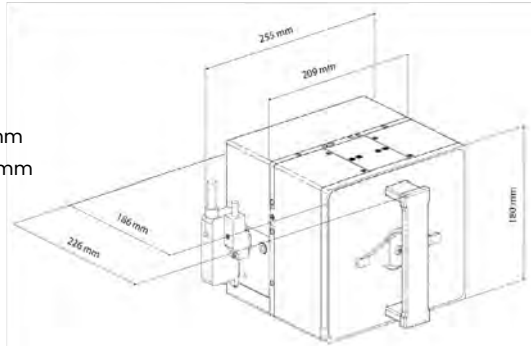

Other characteristics

- Supplies: thermal transfer ribbon available in a variety of grades and colors
- Maximum ribbon length: up to 1100 m
- Minimum ribbon width: 20 mm
- Maximum ribbon width: 55 mm
- Weight: Printer: 7.8 kg, Color controller: 4.5 kg
- Electrical power supply: 90 – 264 V with automatic switching; frequency 47/63 Hz; power 150 VA
- Air supply: 6 bar/90 psi (maximum) dry, uncontaminated
- Air consumption: down to 0.4 ml/print at 2.5 bar
- Operating temperature range: 0 to 40°C
- Humidity: 10% to 90% non-condensing

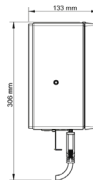
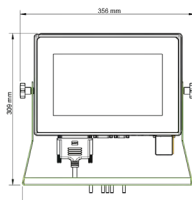
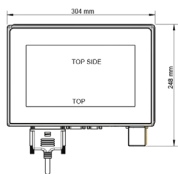

**Scan here
to watch
the video!**



THERMAL TRANSFER SMARTDATE X65



Designed for the most demanding, high-volume applications, the SmartDate X65 delivers high resolution coding on flexible film packaging as fast as 455 packs per minute. Its fully intuitive 10.1" user interface makes daily operations easy and straightforward and provides the most valuable information you need to optimize and enhance your Overall Equipment Effectiveness (OEE) through MI Sigma reporting.

Enhanced SmartDate experience

- Optimized tracking of OEE data: Coder can be configured to monitor your 5 most important production metrics directly from your home screen e.g., pack rate, throughput, availability.
- Tutorials to facilitate daily activities: Animated help and 'how to' tutorials provide guidance on setup and daily maintenance procedures to ensure consistent print quality.
- Profile configurator for error-free operation: Configurable profile password function (operator, supervisor and engineer) manages access and limits human-related errors.



**Scan here to
get the digital
brochure!**



High-performance printing

- Supports your marketing campaigns: Promotional coding function* allows for unique coding on each pack.
- Eliminates faulty codes and protects your brand: In addition to its dead-dot detection system, the easy-to-install SmartDate Detect-Plus system* checks and confirms the presence, position and quality of the code on every pack and directly on the user 10.1" interface.
- Achieves superior printing speeds: Print speed can be set from 10 mm to 1800 mm per second allowing for 455 printed packs per minute at 300 dpi.

Unmatched and cost-effective reliability

- Zero preventive maintenance: Robust direct ribbon drive and cassette design contain no wear parts.
- All-in-one printer for enhanced flexibility: Both intermittent and continuous configurations with a 53 mm printhead are available on the same coder.
- Up to 15%** more codes per roll: Large choice of ribbon rolls based on your packaging type and needs.

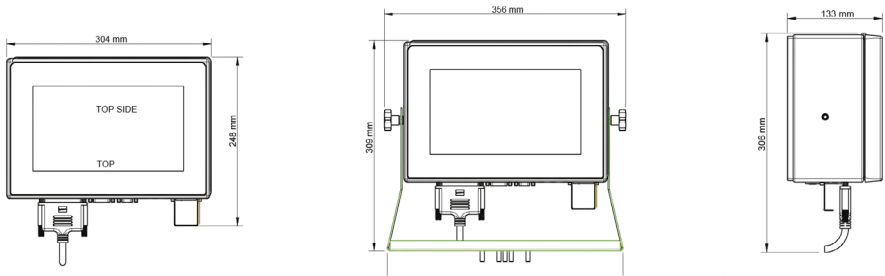

Print features

- **Print speed:**
 - Intermittent: up to 700 mm/s
 - Continuous: 10 to 1200 mm/s (combined)
 - Continuous: 10 to 1800 mm/s (shuttled)
- **Print area:**
 - Intermittent: 53 mm x 75 mm
 - Continuous: 53 mm x 750 mm (combined/application dependent)
 - Continuous: 53 mm x 100 mm (shuttled)
- **Print features:**
 - Automatic printhead setup
 - Detect: Dead-dot detection
 - Quick change print head

- Intermittent and continuous printer
- Easily change from left to right hand with no additional parts
- Gap between prints: 0.5 mm
- Automatic shift codes and serial numbers
- Multiple variable user input fields with alphanumeric texts
- High-pack-rate mode
- **Ribbon-saving mode:** Radial ribbon save, Interlaced mode, Radial mode 1, Radial mode 2, Radial interlaced, Whitespace, Radial whitespace, Step advance
- **Print specifications:** Full TrueType font support, including non-Roman characters and symbols.
- Printing of real-time clock, dates and auto-updating best before dates, barcodes: ITF, Code 39, Code 128, EAN 128, EAN 8, EAN 13, UPC A, UPC E, RSS linear, PDF 417, ID Matrix, QR and Composite RSS barcodes support

Other characteristics

- Supplies: thermal transfer ribbon available in a variety of grades and colors
- Maximum ribbon length: up to 1100 m
- Minimum ribbon width: 20 mm
- Maximum ribbon width: 55 mm
- Weight: Printer: 7.8 kg, Color controller: 4.5 kg
- Electrical power supply: 90 – 264 V with automatic switching; frequency 47/63 Hz; power 150 VA
- Air supply: 6 bar/90 psi (maximum) dry, uncontaminated
- Air consumption: down to 0.4 ml/print at 2.5 bar
- Operating temperature range: 0 to 40°C
- Humidity: 10% to 90% non-condensing

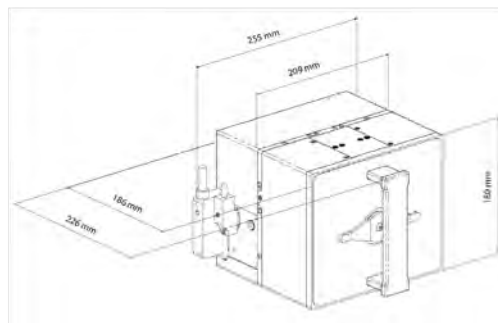

**Scan here
to watch
the video!**



THERMAL TRANSFER SMARTDATE X65-128



Designed for wide format printing applications, the SmartDate X65-128 delivers high-resolution coding on flexible film packaging as fast as 400 packs per minute. Its printhead characteristics make it ideal for wide messages such as ingredient and nutritional coding. Its fully intuitive 10.1" user interface makes daily operations easy and straightforward while providing the most valuable information you need to optimize and improve your Overall Equipment Effectiveness (OEE) through MI Sigma reporting.

High-performance printing

- Delivers extended performance: Up to 128 mm x 150 mm printing area* capacity delivers twice the amount of variable print versus a standard coder thus reducing costs.
- Drives efficiency: Minimizes time and effort by printing multiple codes on multi-lane packaging lines on demand, quickly and efficiently.
- Ensures code quality: Automatic printhead setup optimizes printhead lifetime and allows for deaddot monitoring.
- Achieves superior printing speeds: Print speed can be set from 10 mm to 700 mm per second allowing for more than 400 printed packs per minute at 300 dpi.

Enhanced SmartDate experience

- Optimized tracking of OEE data: Coder can be configured to monitor your 5 most important production metrics directly from your home screen e.g., pack rate, throughput, availability.
- Tutorials to facilitate daily activities: Animated help and 'how to' tutorials provide guidance on setup and daily maintenance procedures to ensure consistent print quality.
- Profile configurator for error-free operation: Configurable profile password function (operator, supervisor and engineer) manages access and limits human-related errors.



**Scan here
to get the
digital
brochure!**



Print features

- **Print speed:**

- Intermittent: up to 700 mm/s
- Continuous: 10 to 700 mm/s

- **Print area:**

- Max: Intermittent: 128 mm x 75 mm
- Max: Continuous: 128 mm x 150 mm*

- **Print features:**

- Automatic printhead setup
- Detect: Dead-dot detection
- Quick change print head
- Combined intermittent and continuous printing
- Easily change from left to right hand with no additional parts
- Gap between prints: 0.5 mm
- Automatic shift codes and serial numbers
- Multiple variable user input fields with alphanumeric texts
- High-pack-rate mode
- **Ribbon-saving mode:** Radial ribbon save, Interlaced mode, Radial mode 1, Radial mode 2, Radial interlaced, Whitespace, Radial whitespace, Step advance
- **Print specifications:** Full TrueType font support, including non-Roman characters and symbols.
- Printing of real-time clock, dates and autoupdating best before dates, barcodes: ITF, Code 39, Code 128, EAN 128, EAN 8, EAN A, UPC A, UPC E, RSS linear, PDF 417, GS1 DataMatrix, QR and Composite RSS barcodes support.

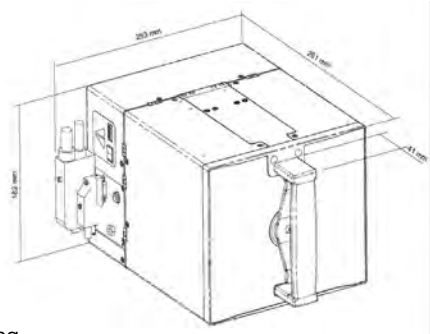

Unmatched and cost-effective reliability

- Zero preventive maintenance: Robust direct ribbon drive and cassette design contain no wear parts.
- All-in-one printer for enhanced flexibility: Both intermittent and continuous configurations are available on the same coder.
- Up to 15%** more codes per roll: Large choice of ribbon rolls based on your packaging type and needs.

Other characteristics

- Supplies: thermal transfer ribbon available in a variety of grades and colors
- Maximum ribbon length: up to 1100 m
- Minimum ribbon width: 55 mm
- Maximum ribbon width: 130 mm
- Weight: Printer: 10.2 kg, Color controller: 4.8 kg
- Electrical power supply: 90 – 264 V with automatic switching; frequency 47/63 Hz; power 150 VA
- Air supply: 6 bar/90 psi (maximum) dry, uncontaminated
- Air consumption: down to 0.4 ml/print at 2.5 bar
- Operating temperature range: 0 to 40°C
- Humidity: 10% to 90% non-condensing

Scan here
to watch
the video!



LASER SMARTLASE C150 / C350



Introducing new, patented “SmartLase Code Technology” embedded into all SmartLase models. This innovative advance includes single and universal fonts as well as algorithms capable of scribing impeccable lines, curves and points faster than ever before.

It delivers two key benefits: 30% greater printing performance with best scribing quality compared to market standards:

- **For the beverage industry:**
Output rate increases from 1,200 to 1,800 bottles/min.
- **For the food industry:**
Character printing capacity of one code increases from 30 to 120 characters, for improved traceability and anti-diversion.

Benefits

- Fast – more than 100,000 products coded per hour.
- Robust – extended coder lifetime by 30%.
- Change of scan head module in 10 minutes without alignments.
- Pointing diode and integrated laser power metre option facilitate diagnostics.
- Job and file transfers through USB port.



Scan here to
get the digital
brochure!



Print features

- Coding on stationary or moving products
- Number of text lines: limited only by character height and allowable print area
- Character height: from 1 mm to 100 mm
- Choice of characters: Chinese, Latin and unicode fonts
- 3 contrast modes: high, medium and low contrasts due to patented "SmartLase Code Technology"
- Wide selection of languages: English, French, Spanish, German, Italian, Portuguese, Brazilian, Chinese, Korean, etc.

Option

- **Coding area and focal distance (mm):**
 - Lens 55 x 55 / fd 80 - Lens 70 x 70 / fd 100
 - Lens 120 x 120 / fd 175
 - Lens 155 x 155 / fd 220
 - Lens 205 x 205 / fd 290
- Remote user interface on 30 W version
- IP65 laser head
- Integrated laser power metre
- 9-metre interconnecting cable length with an optional 90° printhead cable adaptor
- 3-metre cuLUS listed interconnecting cable
- Industrial interface option board: RS-232/422 connectivity, 20 configurable operator /O (12 inputs / 8 outputs), 2 voltage free relays, USB (optional scanners)

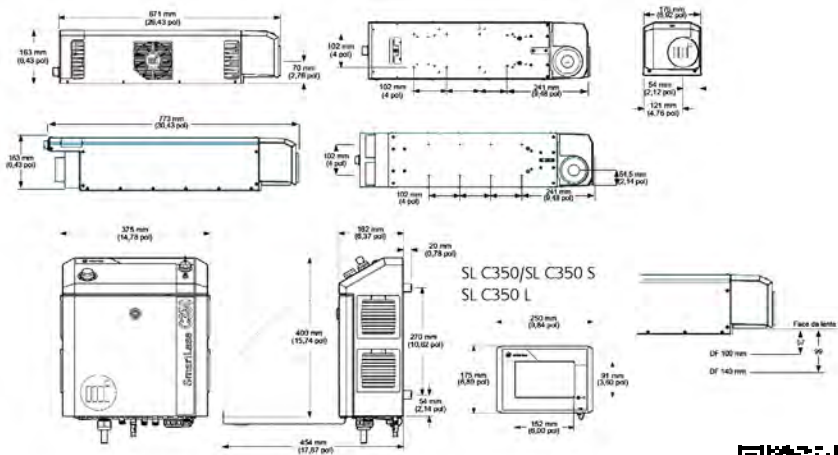

**Scan here
to watch
the video!**



LASER SMARTLASE C350 HD & LHD



Laser coding on stick pack, pouches and wide web, multi-lane application. The right solution whatever the rate, size and substrate of the product (wide choice of lenses, scan heads and laser sources) best quality codes, contrast and consistent character and shape.

Main benefits

- Our 30-watt solution set for wide coding area.
- **Line Efficiency:**
 - Time for product line batch changeover greatly reduced.
- **Eco-Initiatives:**
 - Dedicated fume extraction system for a cleaner, healthier, safer, odourless working environment.
- **High-Quality Coding:**
 - Promotional coding capability on a large range of coloured foils and films with no risk of piercing.
- **Cost Reduction:**
 - Largest print area 500mm x 500mm combined with low maintenance and consumable costs means industry leading low TCO.

Additional benefits

- Text can be located anywhere on the pot lids and in any orientation.
- Last-minute customisation possible (flavour, weight, promotion, etc.) helping to reduce foil inventory.
- Unightly dedicated windows are no longer necessary.
- LHD printhead offers a dedicated solution for laminated foils and stick packs.



**Scan here
to get the
digital
brochure!**



Print features

- High-quality coding up to 35 cycles/min
- **Large marking fields to minimise the number of printheads per line:**
 - One machine up to 24 pots covering 500mm coding width (Fd 430)
 - Two machines up to 48 pots covering 1000mm coding width (Fd 430)
- Compliant with various pot matrix layouts (4x6, 2x8, 4x12)
- Specific L HD (10.2 wavelength) printhead delivers high-quality codes on wide range of laminated substrates and ensures longer lifetime (2-year warranty on laser printer)
- Coding on a large range of coloured foils
- Robust and proven IP54 / IP65 printer design
- Efficient extraction system with automatic flow control optimised for wide coding area (ES500+ solution)
- High-quality coding up to 55 cycles/min
- **Large marking fields to minimise the number of printheads per line:**
 - One machine covering 300mm coding width (Fd 300)
 - Two machines covering 600mm coding width (Fd 300)
 - Three machines covering 900mm coding width (Fd 300)
 - Four machines covering 1200mm coding width (Fd 300)
- Specific L HD (10.2 wavelength) printhead delivers high-quality codes on wide range of laminated substrates and ensures longer lifetime (2-year warranty on laser printer)
- Proven robust IP54 / IP65 printer design
- Efficient extraction system with automatic flow control optimised for wide coding area (ES500+ solution)

Other characteristics

- **CoLOS® software solutions. Networking software solutions:**
 - To centralise production data management
 - To automate the coding task (provides data integrity)
- Ethernet connectivity
- Compliance with 2006 /42 /CE and ISO 13849:2008 (Category 3; Pld)
- Possibility of remote data management
- Long head-to-printer conduit (3, 6, 9m)
- Quick and easy head swap with single connector
- Operating temperature range: 5° to 45°C

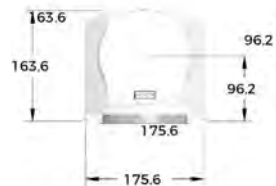
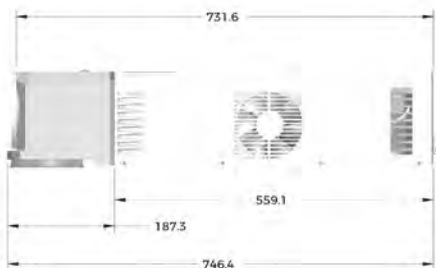

**Scan here
to watch
the video!**



LASER SMARTLASE C600



The SmartLase® C600 CO2 laser coder is the pinnacle of high-speed, high-quality permanent coding from Markem-Imaje. With the SmartLase C600 laser coder, you get reliable laser printing with lower operating expenses and a reduced chemical footprint.

Features

- High-quality, permanent coding on high density substrates
- Lower OPEX with fewer line stoppages, increased efficiency and no chemicals—ensures greater sustainability
- Improved, easier to operate and more intuitive user interface for up to 20% increase in operator efficiency
- Industry 4.0 ready—enabling advanced Packaging Intelligence

Software

- CoLOS® V6 full support includes matrix layout design, promotional coding, OPC UA, PackML V3.0.



**Scan here to
get the digital
brochure!**



Print features

- **Number of text lines:** Limited only by character height and allowable print area.
- **Fonts:** English/Latin, Arabic, Cyrillic, Hebrew, Korean, Japanese (Katakana, Hiragana, Kanji), Chinese (Hanzi) OCR, TrueType** and Unicode
- **1D barcodes:** Code 39, Code 128, Code 2 of 5 (industry), I2 of 5, EAN 8, EAN 13, Code 128-A, Code 128-B, UPC-A, UPC-E, EAN 128, ITF 14
- **2D barcodes:** Data Matrix ECC200, QR Code, HIBC QR Code, Micro QR Code, Aztec, DotCode and HIBC Aztec
- **Logos, graphics:** DXF, PLT, FPS, EPS, PS, SVG, AI, CDR, PDF**
- **Data automation:** Static, user-prompted, alphanumeric counter, serial, external promotional codes (CoLOS only), multi- code/ calculated field (e.g., yyyymmddnnn)
- **Print field manipulation:** Linear, angular, rotation, mirror (SL F600), circular, scaling, matrix (CoLOS only)
- **Time/date handling:** Standard, custom, time / day offsets, prompting BBE date (CoLOS only), start week, update and rounding rules, custom calendars

Printing Speed

- Characters/sec: Up to 2100 char/s (D8 scan head) or up to 1500 char/s (D13 scan head)*
- Product per hour: 150,000 pph*
- Line speed: Up to 900 m/min*

Interface and Control

- **Connections:** Ethernet TCP/IP, PoE and industrial, RS-232, USB, digital I/O, custom programmable outputs, sensor, encoder, shutter, fume extractor controls, alarm beacon, start/stop, safety shutter, dual channel interlocks
- **Pointing diode:** Standard, configurable: rectangle outline, content
- **User interface:** 10"/250 mm touchscreen
- **User interface in languages:** Arabic, Chinese, Croatian, Czech, Dutch, English, French, German, Hebrew, Italian, Korean, Polish, Portuguese, Romanian, Russian, Slovenian, Spanish, Swedish, Turkish, and Vietnamese
- **Other UI options:** Remote PC access via VNC
- **Industrial interfaces:** Optional Interface: OPC UA (CoLOS), PackML V3.0 (CoLOS)
- **Safety interlock:** Two independent interlock circuits (GIC – General Interlock Circuit & SIC – Shutter Interlock Circuit) enable system integration according to category 4 of machinery safety (EN ISO 13849-1) to achieve Performance Level up to PLe.



Scan here
to watch
the video!



LASER LIGHTJET VECTOR

The Lightjet Vector high-power CO2 laser has been designed for the most demanding production environments delivering permanent, consistent, high-quality coding on some of the most challenging substrates such as PE, PP plastics, glass and rubber. This 120 Watts version is the ideal solution for complex messages up to 5-line applications at high production speeds. This vector technology equipped with its articulating arm and compact scanning printhead is well-suited for applications in the beverage, pharmaceutical, cosmetic and personal care industries.



Main benefits

- Capable of printing complex messages at high output rates (up to 1,000 products/minute) without requiring external cooling (no air, no water).
- Ability to print in hot locations (up to 40°C) while maintaining consistent coding quality.
- Proven reliability of the Rofin diffusion-cooled CO2 Slab laser. Thanks to its 120 Watts of power, you can expect consistent quality coding even after several years of intense use.
- Ease of integration within packaging lines (labelling machines) with compact printhead and articulating arm offers up to 1.2 metres of reach.
- Capable of printing on different types of glass, plastics and even on difficult to code labels (gold coated label).

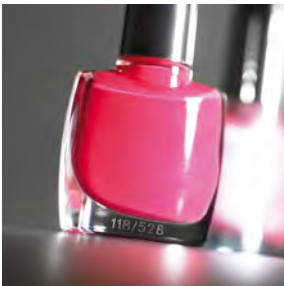

**Scan here to
get the digital
brochure!**



Print features

- Coding on stationary or moving products
- Marking in the direction of product movement or perpendicularly
- **Line speed (max.):** 300 m/min (8 characters, 2 mm high)
- **Marking speed (max.):** 1,000 characters/sec
- **Fixed and variable marking:** text, dates, times, counters, logos
- Set of vectorised fonts, True Type compatible, Asian and Arabic characters, specific font for thin materials (PET)
- Character height from 1 to 50 mm
- **Vast choice of barcodes:** EAN8, EAN13, UCPA, UPCE, Code 39, 2/5 Interleaved, code 128
- **2D codes:** Datamatrix, AZTEC, PDF417, RSS14
- **Coding area (mm):** 105 x 105/fd 150

Options

- **Coding area and focal distance:**
 - Lens 70 x 70/fd 100
 - Lens 140 x 140/fd 200
 - Lens 210 x 210/fd 300
- 7 knuckles articulated arm

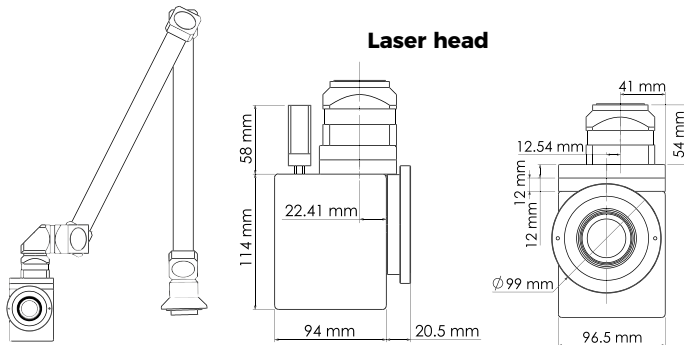

Controller

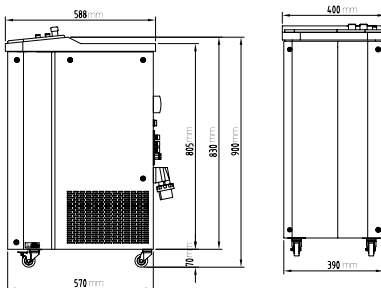

Scan here
to watch
the video!



FIBER LASER CODER F200



For polymers and metals The SmartLase F200 complements our SmartLase C Series CO2 range and is designed to be a high-quality code solution for polymers and bare metals. The F200 provides permanent high-quality, high-contrast codes on a variety of rigid plastics (PE/PP), bare metals and other industries. The permanence of these codes ensures long-term traceability of your products.

Main benefits

- Large choice of lenses to meet specific application needs (message content, speed and substrate)
- Operates as stand alone or online
- High-contrast permanent coding onto metals and plastic to ensure long-term traceability
- Superior laser source lifetime = 100,000 hours
- Operates in environments of up to 35°C (97°F)
- Pointing diode facilitates accurate code placement on the substrate



**Scan here to
get the digital
brochure!**



Print features

- **Production line speed (max):** up to 120m/min
- **Marking speed (max):** up to 1000 characters
- Coding on stationary or moving products
- **Number of text lines:** limited only by character height and allowable print area. Limited to 4 lines if tactile user interface terminal is used.
- Character height: from 1mm to allowable print area
- Logos, graphics, one & two-dimensional barcodes
- Choice of 4 laser fonts
- True Type fonts
- **Coding area and focal distance of the lens (mm, standard):** 100 x 100/fd 162
- Pointing diode (635nm)

Options

- **Wavelength:** 1,06µm
- **Head weight:** 5kg
- **Controller weight:** 21kg
- **Interconnecting cable length:** 3m
- **Controller:** Painted steel
- **Head:** Stainless steel design
- **Dust/humidity protection:** IP44
- No plant air required for cooling
- **Operating temperature range:** 15 to 35°C (59-97°F)
- **Humidity:** 10 to 95% non-condensing
- **Electrical power supply:** 125-230V with automatic switching; frequency 50/60Hz
- **Power consumption:** 3A; 350VA

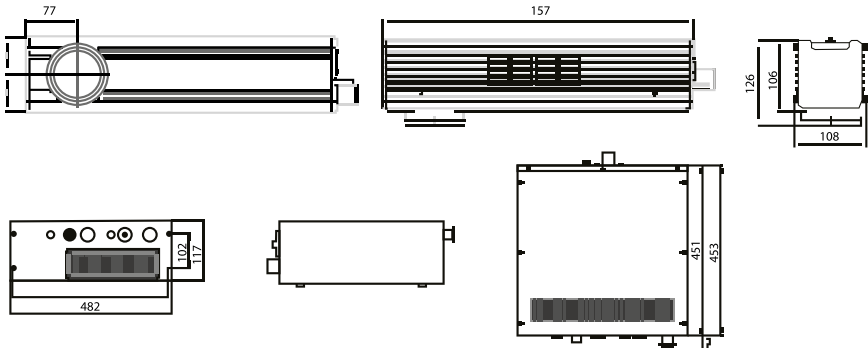

Scan here
to watch
the video!



MARKEM-IMAJE SMARTLASE®

F250

Power in a small package

The intelligent choice for your smart factory

The SmartLase F250 fiber laser coder delivers superb code quality in high-speed applications, even with the increasing code complexity of 1D and 2D codes, all in an easy-to-integrate and easy-to-operate compact unit.



Main benefits

- High-quality, chemical-free and permanent coding on high-density substrates
- Lower operating expenses (OPEX) with fewer line stoppages, higher efficiency and no consumables
- Easy to integrate and operate with an intuitive user interface for improved operator efficiency and reduced risk of human errors
- Industry 4.0 ready
- Pointing diode facilitates accurate code placement on the substrate



**Scan here to
get the digital
brochure!**



Crisp, superb quality, permanent codes

- **Clean, readable and traceable** even at high line speeds and product throughput, minimizing rework and recall costs
- Permanent, indelible marking prevents counterfeiting, protecting brand integrity
- **High-performance** digital galvanometers are driven by a unique algorithm

Lower OpEx, higher efficiency and chemical-free

- Lower operating expenses by eliminating the cost of consumables and external cooling
- Virtually maintenance-free to increase Overall Equipment Efficiency (OEE) and minimize production losses with fewer line stoppages
- Clean and compliant production supports your sustainability goals by eliminating chemical components

Industry 4.0 ready, rugged and safe

- Industry 4.0 optimized with industrial interfaces such as Ethernet/IP, PROFINET, NGPCL and full-featured support for CoLOS® software (part of the Systech Packaging Intelligence Suite™), enabling seamless integration with complex plant automation and manufacturing execution systems (MES)
- Reliable operation in harsh, dusty and humid manufacturing environments with an IP55 controller unit and printhead
- Meets highest safety standards for E-stop and interlock circuits as per ISO 13849-1 / PLe



**Scan here
to watch
the video!**



03

Secondary Coders & Labellers



201701

ANSER

THERMAL INKJET CODER ANSER U2 MOBILE ONE



Print on-the-go with the U2 Anser SMART 1" Mobile Inkjet Printer.

Main benefits

- Compact size with easy-to-read 3.50" LCD screen.
- Handy remote keypad used in label design and printer functions.
- USB 2.0 compatible to be used for software updates, data backup, and stand-alone keyboard use.
- Highly readable 1D and 2D barcodes including: EAN128, Code 128, Code 39, QR, Datamatrix, and many more.



**Scan here to
get the digital
brochure!**



Specifications

- Display: 3.5" Color LCD with LED backlight
- LED Indicators: Alarm, Ink low, Print, Run, Remote on/off
- Input Device: Pocket-sized IR remote keypad
- Print Engine Technology: Thermal Inkjet
- Available Languages: English, Chinese (Traditional), Chinese (Simplified), Japanese, Russian, Korean, German, Portuguese, Spanish, French, Italian, Turkish, Hungarian, Slovak, Czech, Swedish, Romanian, Serbian Latin, Serbian Cyrillic, Bulgarian, Polish, Vietnam
- Max. Printing Resolution: 400(h) x 300(v) dpi (Print quality is dependent on resolution and speed)
- Max. Printing Speed: 60.96 Meters/Mins at 300 dpi setting
- Max. Print Distance: Recommended 6mm from nozzle to surface
- Message Height: "Up to 25.4mm (1 inch) Selectable font size: 2.0mm, 2.8mm, 3.6mm, 5.4mm, 7.2mm, 9mm, 10mm, 11mm, 12.8mm, 16mm, 20mm, 22mm, 25.4mm"
- Print Capabilities: Text, String, Logo, Shift, Counter, DateTime, Expiration Date, Barcode
- Barcodes: Code-128, ITF-14(SCC-14), NVE(SSCC-18), EAN-128, PDF417, Data Matrix, QR Code, DUN-14, GS1 Datamatrix, GS1 DataBar, GS1 DataBar EXP, GS1 QR CODE, UPCA, UPCE, EAN-13, EAN-14, EAN-8, Codabar, Aztec Code, INTER25, CODEBAR, Code-39
- Input/Output: RS-485, RS-232, USB, Wi-Fi
- Message Storage Capacity: Store up to 999 messages
- Operating Temperature: 50C - 400C (410F - 1040F)
- Encoder: Embedded (400DPI)
- Dimensions: 219 mm (L) x136.9 mm, (W) x 143.5 mm (H)
- Weight: 1.13kgs (2.5 lbs) excluding cartridge
- Standard Accessories: Battery, battery charger with adapter, USB disk, remote control
- Optional Accessories: Wi-Fi dongle, RS-485 to USB converter, Clock stabilizer
- PC software: Message Pro II, Net Commander
- Printer Control Protocol: ANSER U2 Net Protoco

**Scan here
to watch
the video!**



THERMAL INKJET CODER ANSER U2 SMART INKJET



The U2-Smart Inkjet offers the most cost-effective solution with exclusive ink selections for porous & semi-porous printing applications.

Main benefits

- Compact Size with 3.5-inch LCD Screen - Feature a larger screen to provide a better user experience, while maintaining its compact body size for hassle-free installation and easy integration.
- Zero Maintenance - The ink cartridge design eliminates unnecessary printhead services; it is truly zero maintenance and has drastically decreased your total cost of ownership.
- Pocket-sized Remote Keypad - Handy and compact remote keypad with comprehensible design for easy operation.
- Friendly UI & Intelligent Dashboard - Simple yet elegant user interface for easy operation. The intelligent dashboard design monitors the printer status and provides real-time system notifications.
- Dust Cover Design - Help to protect cartridge from getting damaged in dusty environment.
- USB 2.0 Compatible - Multiple functions including software update, data backup and stand-alone USB keyboard operation.
- Anti-Shock Mechanism Design - Anti-shock mechanism design to eliminate the unexpected damage to your printer with ANSER's unique protective design.
- Automatic Ink Identification - Automatically identifies and selects the proper firing parameter to ensure the best print quality.
- High Readable Rate Barcodes - Capable of printing crisp 1D & 2D barcodes including EAN 128, Code 128, Code 39, Data Matrix, QR Code, and etc.



**Scan here
to get the
digital
brochure!**



Print features

- Display: 3.5" Colour LCD with LED backlight
- User Interface: Simple and easy-to-use operating system
- Input Device: Pocket-sized IR remote keypad
- Available Languages: English, Japanese, French, German, Spanish, Portuguese, Russian, Korean, Italian, Turkish, Hungarian, Slovak, Czech, Swedish, Romanian, Serbian, Bulgarian, Chinese (Traditional & Simplified)
- LED Indicators: Alarm, ink low, print, run, remote on/off
- Print Engine: Hewlett-Packard thermal inkjet technology
- Print Resolution & Print Speed: 600 x 300 dpi (76.2 m/min) Print quality is dependent on resolution and speed
- Print Distance Recommended: 6mm
- Print Height: Up to 4 lines and 12.7mm (0.5"). Selectable font size from 2.7mm, 3.6mm, 5.5mm, 8mm, 10mm, 12.7mm
- Print Capability: Alphanumeric, logos, date/time, shift code, counter, lot box code
- Barcodes: Code-128, ITF-14(SCC-14), NVE(SSCC-18), EAN-128, PDF417, Data Matrix, QR Code, DUN-14, GS1 DataBar, UPCA, UPCE, EAN-13, EAN-8, Code 25 Interleaved, Codabar, Code-39
- Electrical Requirements: AC 100V~240V, 50/60Hz
- Weight: 0.49kg (1.08 lbs) - Cartridge and brackets not included
- Dimensions: 114 (L) x 76 (W) x 60 (H) mm
- Mounting Orientation: Horizontal or downside
- Message Storage Capacity: Store up to 999 messages
- Operating Temperature: 5°C – 40°C (41°F – 104°F)
- Data Interface: RS485 & USB



**Scan here
to watch
the video!**



THERMAL INKJET CODER ANSER U2 SMART ONE



The U2-Smart offers the most cost-effective solution with exclusive ink portfolio for porous and semi-porous printing applications.

Main benefits

Zero-maintenance

The coder weighs only 0.49 kg (1.08Lb).

Compact Size with 3.5-inch LCD Screen

Feature a larger screen to provide better user experience, while maintaining its compact body size for hassle-free installation and easy integration.

Pocket-sized Remote Keypad

Handy and compact remote keypad with comprehensible design for easy operation.

Friendly UI & Intelligent Dashboard Design

The simple yet elegant user interface for easy operation. The intelligent dashboard design monitors the printer status and provides real-time notifications



Scan here to
get the digital
brochure!



Print features

- Display: 3.5" Color LCD with LED backlight
- User Interface: Simple and easy-to-use operating system
- Input Device: Pocket-sized IR remote keypad
- Available Languages: English, Japanese, French, German, Spanish, Portuguese, Russian, Korean, Italian, Turkish, Hungarian, Slovak, Czech, Swedish, Romanian, Serbian, Bulgarian, Chinese (Traditional & Simplified)
- LED Indicators: Alarm, Ink low, Print, Run, Remote on/off
- Print Engine: Hewlett-Packard Thermal Ink Jet Technology
- Print Resolution & Print Speed: 600 x 300 dpi (76.2 m/min) Print quality is dependent on resolution and speed
- Print Distance Recommended: 6mm
- Print Height: Up to 4 lines and 12.7mm (0.5"). Selectable font size from 2.7mm, 3.6mm, 5.5mm, 8mm, 10mm, 12.7mm
- Print Capability: Alphanumeric, logos, date/time, shift code, counter, lot box code
- Barcodes: 128, ITF-14(SCC-14), NVE(SSCC-18), EAN-128, PDF417, Data Matrix, QR Code, DUN-14, GS1 DataBar, UPCA, UPCE, EAN-13, EAN-8, Code 25 Interleaved, Codabar, Code-39
- Electrical Requirements: AC 100V~240V, 50/60Hz
- Weight: 0.49kg (1.08 lbs) - Cartridge and brackets not included
- Dimensions: 114 (L) x 76 (W) x 60 (H) mm
- Mounting Orientation: Horizontal or downside
- Message Storage Capacity: Store up to 999 messages
- Operating Temperature: 5°C – 40°C (41°F – 104°F)
- Data Interface: RS485 & USB

Optional Accessories

- **Encoder:** Provide high print quality on unstable conveyor
- **Photocell:** Provide more reliable and precise sensing parameter
- **Alarm Kit:** Alert users in the event of an incident

Scan here
to watch
the video!



LARGE CHARACTER VALVEJET 4500



*39,000 coded boxes with just one litre of ink!
Bring unmatched value to your production
line with the new 4500 valvejet coder.*

Main benefits

- One button only, to activate/deactivate print.
- Operator interface: intuitive icon-based WYSIWYG 5.7" (144.8 mm) touchscreen.
- Interface available in 32 languages: Arabic, Brazilian, Bulgarian, Chinese (simplified), Croatian, Czech, Danish, Dutch, English, Finnish, Greek, Hebrew, Hungarian, Indonesian, Italian, Japanese, Korean, Norwegian, Farsi, French, German, Polish, Portuguese, Romanian, Russian, Slovenian, Spanish, Swedish, Taiwanese, Thai, Turkish, Vietnamese.
- 3 user levels (Operator, Advanced Operator and Administrator).
- Full message editor included.
- Instructions can be given in one language while messages can be printed in another language and/or character set.
- Import/export jobs and printer settings through USB.
- Direct purge button function on controller for convenient cleaning.
- Supplied as complete functional system 'out-of-the-box'.



**Scan here to
get the digital
brochure!**



Print features

- Two water-based ink colours – black and red – for porous substrates
- 0.5 or 1L ink bottle, with ink level alarm. Indication of remaining ink on the screen
- Seven nozzle print heads to print one line of 13 mm or 24 mm
- 16 nozzle print heads to print one line of 29 or 56 mm or two lines of 13 or 24 mm each
- Prints text, time, date, expiration dates, shift code, counters, images (png or bmp)
- Calendar feature for custom date formats
- 200 messages minimum of 100 characters each
- Character width adjustment
- Print delay for message placement
- Top and side printing
- 2–20 mm print distance between the printhead and the object
- Print direction from right or left
- Print speed up to 60 m/min
- **Ink circuit:**
 - Internally regulated
 - No adjustments needed. No need of plant air
- **Character sets:** Unicode capability. Latin, Arabic, Cyrillic, Chinese (simplified), Chinese (traditional), Greek, Hebrew, Japanese, Thai, etc.
- Support for True Type and BDF-font format
- **Font matrix:**
 - 7N: 5x5, 7x5
 - 16N: 5x5, 5x7, 12x10, 16x10

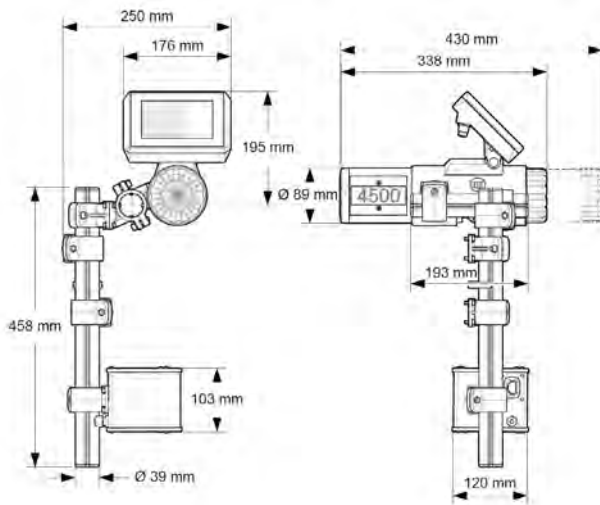

Scan here
to watch
the video!



DROP-ON-DEMAND VALVEJET 4700

Facilitate logistics with the 4700's proven drop-on-demand valvejet technology. The 4700 is quick and easy to install and operate. It offers numerous low-resolution text and logo options in several colours for porous, semi-porous and non-porous surfaces or products. Its extended ink capacity enables you to maximise production uptime while its reserve tank allows for consumable changes without stopping your line.



Main benefits

- Made to fit on any line
- The compactness of this coder makes it the perfect solution for some of the most inaccessible production lines and environments. Printing on a variety of packages and materials (lumber, wallboard, etc.), it easily integrates with other equipment via I/O connection for message select, error output, and weight scale integration.
- Effortless image creation with 7" colour touchscreen.
- Using intuitive icons, operate and design codes in your local language with Latin, Arabic, Cyrillic, Chinese, Greek, Hebrew, Thai, etc. characters.
- Your product, your print. Identify your products with your choice of static text, date, time, expiration date, shift code, counter, and even logos, in your choice of eight font sizes.
- Improve readability. Use one printhead for simplicity or two, with the second printhead mounted on the opposite side of the case, to make the codes visible from all directions.
- Flexibility to print on a variety of materials. Choose from a wide ink offering, in black or colour, for your porous or non-porous packaging or materials such as cardboard, coated cardboard, plastic, glass, metal, PVC, and wood. Codes will remain readable even in the most challenging storage conditions.
- Reduced logistics errors with large characters. With your choice of the 7 or 16 nozzle printhead, print up to 56 mm high codes with a single printhead or stitch print with two printheads together to create a code with up to 114 mm characters. Message will be legible from afar helping to simplify internal logistics and avoid errors.
- Add ink without stopping your line. 20L ink canister allows for more product coding and can be changed during production thanks to the additional reservoir.
- Increased throughput
- Run your line up to 90 m/min to get more product out the door.
- Constructed to be IP54 compliant. Ensures reliable operation even in a dusty environment and when splashed with water.

**Scan here
to get the
digital
brochure!**



Print features

- 4 water-based ink colours – black, red, blue, and clear (UV visible) for printing on porous paper, cardboard, plasterboard, or pulp; two propanol-based colours – black and red for printing on non-porous coated paper; red ethanol-based for printing on wood; and black ethyl acetate-based for printing on non-porous high-gloss coated surfaces, plastic, HDPE, cellophane, PVC, metal and glass
- 5 L or 20 L ink canisters, with ink level alarm, and indication of remaining ink on the screen
- One or two printheads
- 7 nozzle printheads to print one line, maximum 24 mm
- 16 nozzle printheads to print up to two lines, and up to maximum 56 mm
- (2) seven nozzle printheads print two independent lines, each up to maximum 24 mm
- (2) 16 nozzle printheads may print independent images, each up to maximum 56 mm
- (2) 16 nozzle printheads also print a single interconnected image up to maximum 114 mm
- Prints text, time, date, expiration dates, shift code, counters, image (png or bmp)
- Prints variables supplied from an external source via the serial port
- Calendar feature for custom date formats
- Stores at least 800 messages
- Character width adjustment
- Print delay for message placement
- Top, side, opposite side, and bottom printing
- 2–20 mm print distance between the printhead and the object (<5 mm recommended for best print quality)
- Print in any direction

Ink circuit:

- Internally regulated
- No adjustments needed and no plant air needed
- **Character sets:** Unicode capability: Latin, Arabic, Cyrillic, Chinese (simplified), Chinese (traditional), Greek, Hebrew, Japanese, Thai, etc.
- Support for True Type and BDF-font format
- **Font matrix:**
 - 7N: 5x5, 7x5
 - 16N: 5x5, 5x7, 12x10, 16x10
 - (2) 7N: 5x5, 7x5, 12x7
 - (2) 16N: 5x5, 7x5, 12x7, 16x10, 25x19, 32x24
- Five printhead slant angles for finer resolution at reduced print heights

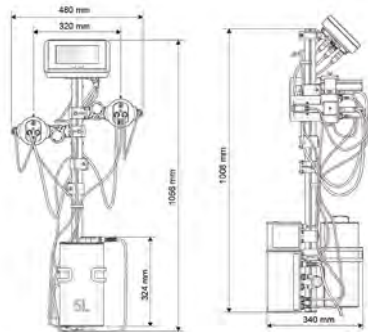

Scan here
to watch
the video!



PRINT AND APPLY LABELLING 2200 SERIES



The new 2200 Series builds on a proven concept providing reliability, efficiency and ease of use with thousands of units installed in demanding 24/7 environments. The 2200 Series takes print and apply to the next stage of evolution, giving you a wide range of interchangeable applicators, optimised operational intervention and unparalleled application rate.

Main benefits

- Ability to print and apply at rates up to 125 packs per minute regardless of the data complexity or content.
- Simple media path allows operators to reload label and ribbon rolls in less than 40 seconds.
- 560 m ribbon and label rolls compared with the market standard of 450 m to reduce the line stoppages by 25%.
- Compliant ANSI grade A/B codes even at the highest application speed.
- CoLOS® software solutions ensure product data integrity, central data management and easy connection to existing enterprise database.
- CoLOS Terminal®, the new colour touchscreen, enables easy selection of labels to be printed and powerful data management through an intuitive user interface.
- Designed to be over 95% recyclable.



**Scan here to
get the digital
brochure!**



Options & Accessories

- Inside wound label kit
- Local industrial terminal with QWERTY keypad and backlit display
- Enhanced onboard user interface
- Label selection
- Machine back-up/restore or cloning
- Expanded memory SD card slot
- Scalable and international fonts
- Three-colour-status beacon
- Barcode reader
- Range of industrial stands
- CoLOS Terminal

Print features

- **Print methods:** Thermal transfer or direct thermal
- Built-in real-time clock
- 10 individual programmable counters
- **Print engines:**
 - **2220:** 56 mm, 200 dpi (8 dots per mm)
 - **2230:** 54 mm, 300 dpi (12 dots per mm)
 - **2420:** 104 mm, 200 dpi (8 dots per mm)
 - **2430:** 108 mm, 300 dpi (12 dots per mm)
 - **2620:** 168mm, 200 dpi (8 dots per mm)
 - **2630:** 162 mm, 300 dpi (12 dots per mm)
- **Maximum print speed:** 300 mm/s
- **Fonts:** 16 smooth scalable fonts available
- True Type font downloadable
- Support for Unicode fonts
- **Graphic features:** BMP, WMF, PCX, PNG, ICO, GIF, TIFF, JPEG
- All major linear barcodes and 2D barcodes supported
- **Applicators:**
 - Tamp, Blow, Wipe or Tamp Blow for top, side and front applications
 - Corner Wrap for two adjacent side applications

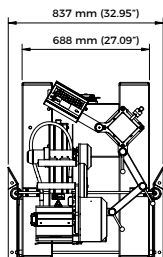
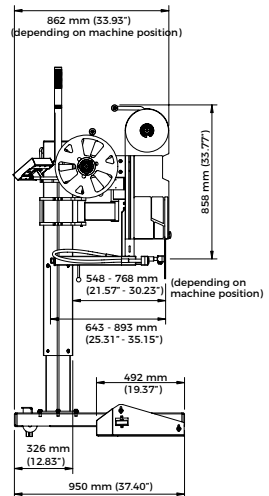
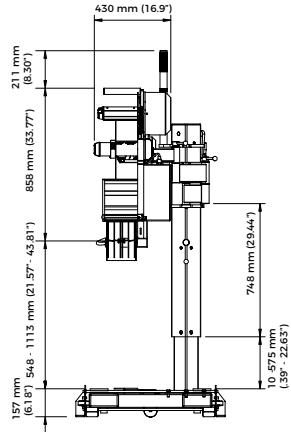

Dimensions refer to 2200 Tamp Long

Scan here to watch the video!



PRINT AND APPLY LABELLING 2200 eTouch S



With a proprietary design and several patented technologies, the cutting-edge eTouch-S applicator for the 2200 Series utilizes Markem-Imaje's market leading innovation to combine outstanding performance with the highest levels of operational safety.

Main benefits

- Ensuring the highest safety standard
 - Fully compliant to EN-4510. No operational risk and no guarding required, even at extreme speeds.
- Artificial intelligence for more output
 - The unique SoftTouch technology offers highly accurate coding on variable pack size without unnecessary force or throughput reduction.
- Lower impact on the environment
 - No factory air required for contact applications. Reduce air consumption up to 95% on blow mode with the advanced EcoFlow pad.

Designed for accurate labeling with minimal demands on factory resources

The innovative eTouch-S applicator is the preferred end-of-line solution to ensure "A" grade GSI compliant barcodes on all your corrugated and shrink-wrapped cases, trays and packs.



**Scan here to
get the digital
brochure!**



**Scan here
to watch
the video!**



LARGE CHARACTER HIGH-RESOLUTION PIEZO 5800



The 5800 large character inkjet printer represents the next generation of Touch Dry® Hot Melt technology delivering a superior print quality coding solution for your corrugated cases, trays and wrapping films. Pyrotec PackMark's Touch Dry® Hot Melt inks are solvent-free and environmentally friendly. Codes and messages never bleed or fade, dry on contact and deliver 100% readable, GS1 compliant codes.

Main benefits

- Touch Dry® Hot Melt inks print on a wide range of substrates and in environments ranging from 0 to 40 °C.
- The printer, boasting print speeds up to 182 m/min, can be equipped with optional printhead slide assembly optimising both print gap control and print quality.
- Cutting edge communication capabilities include colour touchscreen, Ethernet, USB, and web user interface, providing increased flexibility and functionality to end users, integrators and OEMs.
- Optional CoLOS® Enterprise networking software is available for central management of data from remote databases or ERP systems.
- Compact, modular design for stand alone operation or complete integration.
- Advanced printer design provides quick start up and minimises overall energy consumption.
- Uptime features include a unique programmable self maintenance system and ink reloading capability during operation.
- Touch Dry® solid ink blocks are easily handled for simple and trouble free operation.



**Scan here to
get the digital
brochure!**



Print features

- **Printhead dpi:**
 - **Vertical dpi:** 200
 - **Addressable Jets:** 256
 - **Nozzles:** 512
- **Print speed - continuous:**
 - Print density 1 - 200 by 150 dpi
 - Up to 182 m/min
 - Print density 2 - 200 by 300 dpi
 - Up to 91 m/min
 - Print density 3 - 200 by 450 dpi
 - Up to 61 m/min
 - Print density 4 - 200 by 600 dpi
 - Up to 45 m/min
 - Print density 5 - 200 by 750 dpi
 - Up to 36 m/min
- **Print densities available:** 1 to 8
- **Encoder scaling:** allows for conveyor line speed matching and for higher print speeds with a reduction in print resolution
- **Print area - maximum/printhead:**
 - **Print height:** 65 mm
 - **Print length:** 1,000 mm
- **Print specification:** full True Type font supported
- Printing of real-time clock (hr/min), dates and auto-updating best before dates and serial numbers.
- Barcodes (Linear and 2D): ITF, Code 39, Code 128, EAN 128, EAN 8, EAN 13, UPC A, UPC E, Datamatrix, RSS linear, RSS composite, QR, RSS 14, RSS expanded, PDF 417

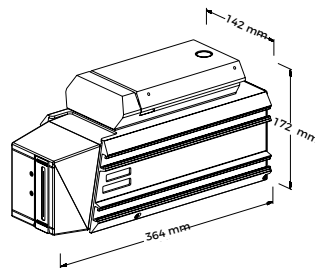
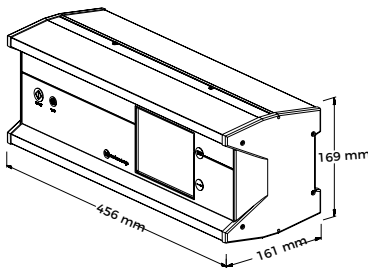

**Scan here
to watch
the video!**



TOUCH DRY® HIGH RESOLUTION INKJET CODER 5940 G



The 5940 G sets the standard of coding quality, compliance, operational efficiency and reduced total cost of ownership (TCO) with a sustainable solution. Greater throughput and compliant barcodes including GS1-128 requirements.

The piezo inkjet drop-on-demand printer offers a faster return on investment by boosting production throughput while enabling manufacturers to improve their supply chain management through traceability and brand protection. That's printing intelligence beyond the mark.

Main benefits

- Superior coding solution ensures readability and compliance
- A solution designed for increased availability and production output
- Legendary 5000 series advantages: a sustainable investment



**Scan here to
get the digital
brochure!**



Print features

- **Printhead dpi:**
 - **Vertical dpi:** 200
 - **Addressable Jets:** 256
 - **Nozzles:** 512
- Print densities available: 1 to 10
- Encoder scaling: Allows for conveyor line speed matching and for higher print speeds with a reduction in the print resolution
- Print area: Maximum/printhead print height: 65 mm (2.56") Print length: 3 m (118.11")
- Print fonts: Full TrueType fonts supported
- Printing of real-time clock (hr/min/sec), dates and auto updating best before dates and serial numbers
- Barcodes (linear and 2D): ITF, Code 39, Code 128, GS1-128, EAN 128, EAN 8, EAN 13, UPC-A, UPC-E, DataMatrix, RSS linear, RSS composite, QR, RSS 14, RSS expanded, PDF 417

Other Characteristics

- Weight: Printhead (PH): 2.1 kg
 - Controller: 2PH - 50 kg. / 111 lbs., 4PH - 53 kg. / 116 lbs.
 - Controller base with castors: 16.8 kg
- Touch Dry® hot melt inks available in various series, colors packaged in bottles
- Electrical and environmental: 100-240VAC, 50/60Hz
- Operating environment of 0 to 40 °C (32 to 104 °F)
- IP54 (cabinet only)
- Manuals: Safety manual included, all other manuals are accessed via Markem-Imaje website
- Local language versions for the color user interface

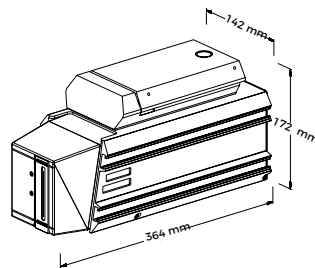
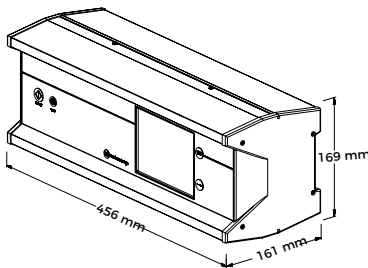

**Scan here
to watch
the video!**





04
Tertiary
Labellers

PRINT AND APPLY LABELLING 2200 PALLET

The 2200 Pallet builds on a proven concept providing reliability, efficiency and ease of use in demanding 24/7 environments.

The 2200 Pallet takes print and apply to the next stage of evolution, giving you optimised operational intervention and unparalleled reliability.



Main benefits

- One or two side pallet labelling at speeds up to 120 pallets per hour.
- Unique compact design and robust swing arm applicator makes it the perfect long-term investment.
- Simple media path allows operators to reload label and ribbon rolls in less than 40 seconds.
- Compliant ANSI grade A/B codes even at the highest application speed.
- CoLOS software solutions ensure product data integrity, central data management and easy connection to existing enterprise database.
- Designed to be over 85% recyclable.



**Scan here to
get the digital
brochure!**



Print features

- **Print methods:** Thermal transfer or direct thermal
- Built-in real-time clock
- 10 individual programmable counters
- **Print engines:**
 - **2620:** 168mm, 200 dpi (8 dots per mm)
 - **2630:** 162 mm, 300 dpi (12 dots per mm)
- **Maximum print speed:** 300 mm/s
- Swing arm for one and two adjacent side applications
- **Label application time cycle:**
 - **Single linear movement:** 7 s
 - **Single side movement:** 10 s
 - **Two adjacent side movement:** 20 s
- **Fonts:** 16 smooth scalable fonts available
- True Type font downloadable
- Support for Unicode fonts
- **Graphic features:** BMP, WMF, PCX, PNG, ICO, GIF, TIFF, JPEG
- All major linear barcodes and 2D barcodes supported
- Left and right applicator versions (frontside, backside)

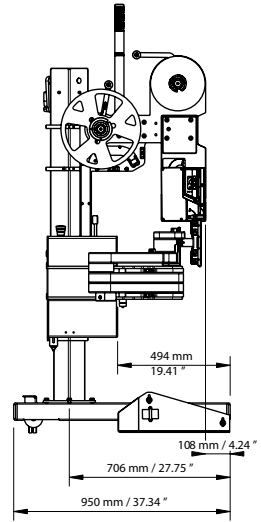

Options & Accessories

- Inside wound label kit
- Expanded memory SD card slot
- Scalable and international fonts
- Three-colour-status beacon
- Barcode reader
- Floor stand and docking station

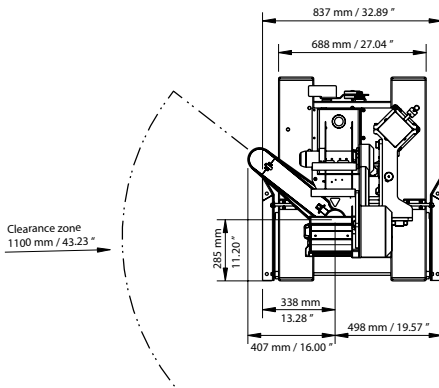
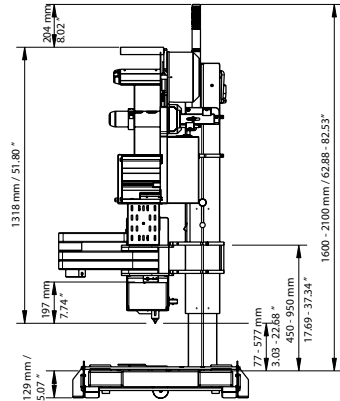

Scan here
to watch
the video!



PRINT AND APPLY LABELLING CIMPAK

CimPak pallet labeling systems have earned a reputation for quality and reliability in the toughest of manufacturing environments. Their design offers a flexible, scalable solution for achieving the ultimate traceability in warehousing and inventory control.



Main benefits

- **Uptime** – Synchronized ink ribbon roll change thus maximizing uptime. Built-in user interface with simple button operation and service diagnostics.
- **Performance** – Maximize productivity with proven, accurate pallet labeling up to 4 labels on 3 sides (front, side and rear) with 100% readable barcodes at speeds up to 120 pallets per hour to meet customer demands.
- **Connectivity** – Flexible integration into packaging lines, databases and ERP systems via CoLOS® Enterprise Software.
- **Traceability** – Each unique pallet label can be identified and tracked at every step of its journey, from when it leaves your facility to its final destination.



**Scan here to
get the digital
brochure!**



Print features

- Print methods: Thermal transfer or direct thermal
- Maximum print width 152 mm
- Standard application pad 150 x 210 mm (minimum label size 75 x 105 mm)
- Print resolution/speed 200 dpi 150 mm/sec
- Up to 120 pallets per hour
- Application rate two labels in 14 seconds (front and side)
- Flexible tamp application front, front/side, side, front/side/rear, rear/side, rear
- Active pallet detection for uneven or variable pack configurations
- Applicator stroke 2 axis 500 x 500 mm or 500 x 750 mm
- Flexible installation options with machine hand and multi position applicator head
- Built-in real time clock
- All major barcodes supported
- Logos and images supported

Operations

- Full interactive backlit interface with function key operation (no pc required)
- Full on screen fault diagnostics
- Part pallet sensor for low pallets, allowing pallets to pass or manual label application
- Emergency stop button with remote connection
- Stand alone operation with on-board database function
- Barcode reader input
- Programmable re-apply sequence or fault after barcode failed read
- RS232/422/485 serial interfaces

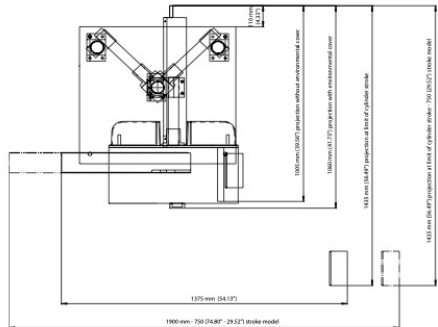
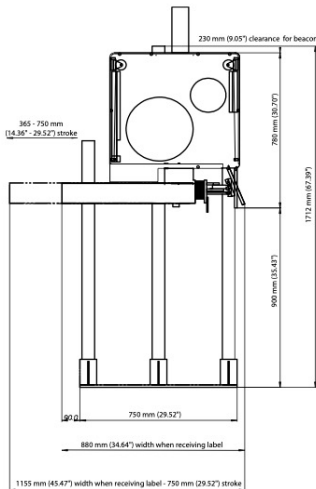

Scan here
to watch
the video!



05 Labellers



ENTRY LEVEL LABEL APPLICATORS LABEL DISPENSERS



115mm Wide Label Dispenser

- Dividers aid in the positioning of rolls
- Manufactured with holes to mount on walls



220mm Wide Label Dispenser

- Dividers aid in the positioning of rolls
- Manufactured with holes to mount on walls



320mm Wide Label Dispenser

- Dividers aid in the positioning of rolls
- Manufactured with holes to mount on walls

**Scan here to
get the digital
brochure!**



**Scan here
to watch
the video!**



ENTRY LEVEL SELF-ADHESIVE LABELLERS MHL



Pyrotec PackMark supplies metal manual hand labellers for even the smallest manufacturer at an affordable price. The metal manual hand labeller labels the front and back labels of a product which ensures a professional appearance on any glass or plastic container.

This low maintenance machine is ideal for industries with small production runs, as no time is taken to position the label as with hand labelling.

Application requirements

- The MMHL can handle wine bottles from 187 ml to 1.5 L.
- It can also label various other containers such as securitainers, tubes and containers up to 2 L, depending on the application requirements.



**Scan here to
get the digital
brochure!**



**Scan here
to watch
the video!**



LABELLING CYLINDRICAL OBJECTS BOTTLE-MATIC



Bottle-Matic is the perfect machine for labelling cylindrical objects and saving time! It can be used to apply either single or double sided labels to round containers. This unit is great for short run wine and beer labelling as well as jellies, jams, sauces, and spice containers. It can wrap bottles, cans, tubes and jars by simply pressing the footswitch. Tapered objects can also be done without any customisation.

Technical specifications

- 250mm or 400mm width cylinder labelling machine
- Label objects fast and accurately FRONT and BACK
- 12.5mm to 250mm diameter at speeds of 1,200 pieces per hour
- Photoelectric sensor with patented IR pulsing technology
- Complete changeover in under two minutes
- Fine adjustments for tapers

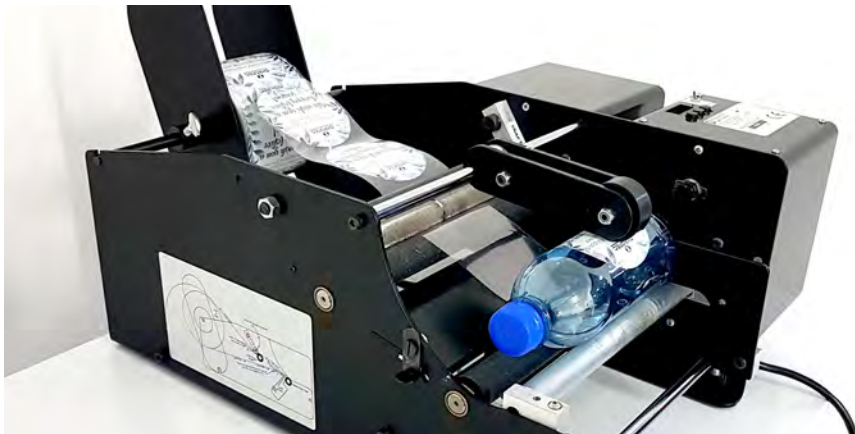

**Scan here to
get the digital
brochure!**



**Scan here
to watch
the video!**



CODING AND LABELLING PACKWRAP



The built-in English touch screen panel and the visual parameter makes it easier to test and adjust the machine. High quality conveyor belt. The working speed of the conveyor belt can be adjusted according to production needs. The labelling belt helps to ensure that there are no bubbles under the stickers. The tightness of the belt can be adjusted by loosening or tightening the screw.

Technical specifications

- **Labelling Speed:** 45 products per minute
- **Label Length:** 370mm
- **Label Height:** 25mm (Min) to 125mm (Max)
- **Products That Can Be Labelled:** Round or tapered products
- **Suitable Bottle Diameter:** About 30 - 100mm
- **Conveyor Size:** 1310mm X 100mm
- **Voltage:** 110V - 60Hz or 220V - 50Hz
- **Roll Inside Diameter:** 75mm
- **Roll Outside Diameter:** 250mm
- **Construction of Labeller:** 50% Stainless, 25% aluminium and 25% Mild steel



**Scan here to
get the digital
brochure!**



**Scan here
to watch
the video!**



ENTRY LEVEL SELF-ADHESIVE LABELLERS ELDH

Pyrotec PackMark supplies manual or semi-auto labellers for even the smallest manufacturer at an affordable price.

The ELDH applicator is a compact and low-cost automatic labeller for self-adhesive labels. Labelling speeds of up to 35 labels per minute can be attained, depending upon label size. This applicator is capable of dispensing labels from 20mm X 20mm minimum size to 100mm X 100mm maximum size.



Electrical

- **Power:** 360 W
- **Frequency:** 50Hz
- **Current:** 1,5 A
- **Voltage:** 240 V
- **Phase:** single
- **Variable speed:** up to 50 ppm
- Stepper motor Drive for constant and accurate labelling position.

Mechanical

- **Dimensions:** 500mm wide x 700mm long x 320mm high
- **Approx Weight (excl bracket):** 6,7 kg
- **Diameter of reel of labels:** 220mm

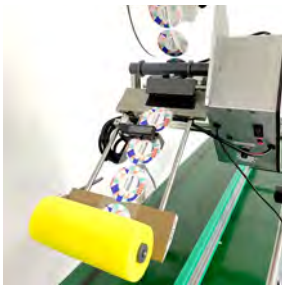

Scan here to
get the digital
brochure!



Scan here to
watch
the video!



SELF-ADHESIVE LABEL APPLICATOR ALSTEP E & S



The ALstep is a compact sized and low-cost applicator for self-adhesive labels, which can be easily integrated into already existing packaging lines. The ALstep is based on a robust, reliable mechanical structure; it can be fitted into particularly restricted areas, thanks to the side access web threading allowing a fast, easy label changeover.

The ALstep can hold label rolls up to 300 mm diameter for a long operating time; it is equipped with a separate control box with cooling fan, which makes it possible to operate it in harsh industrial environments.

This system comes in both S and M versions, for label widths up to 100 and 200 mm respectively. Its maximum label dispensing speed is as high as 25 m/min. (20 m/min. in the M version) thanks to a microprocessor controlled stepper motor enabling the operator to enter all labelling parameters by means of the display and function keys.

In more detail, the following functions are available:

- Adjustment of label dispensing speed
- Pre-dispensing adjustment
- Labelling delay adjustment in millimetres
- Automatic recovery of missing labels
- Progressive counter
- End-of-roll alarm and web break alarm
- Contact for connection to other systems

Additionally, the ALstep can be equipped with an array of optional devices to solve specific labelling problems, such as:

- Hot foil printing unit
- Thermal transfer printing module
- Pneumatic and air-blow applicators
- Near-end-of-roll sensor
- Speed control via encoder
- Label tracing by thickness capacitive sensor

**Scan here
to get the
digital
brochure!**



The ALstep is also available in the E (Economical) version for label widths up to 100 mm at a maximum speed of 15 m/min; it is ideal for the applications where cost reduction is a crucial requirement.

The control panel makes it possible to adjust the main functioning parameters (speed and predispensing) by means of digital indicators (contraves), emitting an end-of-roll or webbreak alarm signal. A label sensor for transparent material is optionally available.

Technical specifications

	ALSTEP E	ALSTEP S	ALSTEP M
Label width max mm.	100 mm	100 mm	200 mm
Max speed	15 m/min.	25 m/min.	20 m/min.
Control	Contraves	Display & function buttons	Display & function buttons
Label position	Manual	Electronic	Electronic
End-of-roll and web break alarm	S	S	S
Recovery of labels missing	N	S	S
Pieces counter	N	S	S
Transparent label sensor	O	O	O
Coder/TT Printer	N	O	O
Checking device for near end of reel	O	N	O
Pneumatic applicator	N	O	O
Encoder	N	O	O
Unwind unit diam.	300 mm	300 mm	300 mm
Power Supply	240V - 50Hz	240V - 50Hz	240V - 50Hz
Power Consumption	400W	400W	400W

O = Optional | S = Current | N = Not Available

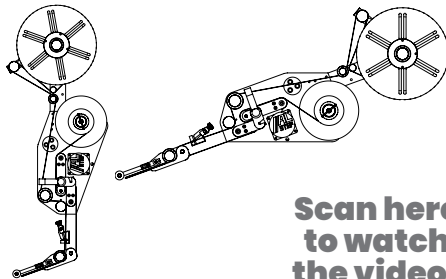
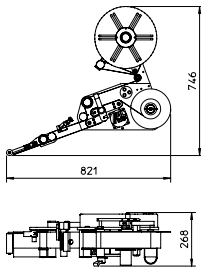

Scan here
to watch
the video!



SELF-ADHESIVE LABEL APPLICATOR ALRITMA



ALritma consists of a range of high-performance applicators for self-adhesive labels, designed to be installed on packaging lines where production speed, accuracy and reliability are primary needs. ALritma labelling units are based on an innovative mechanical structure which can match great sturdiness with versatility.

The applicator is controlled by a powerful microprocessor equipped with a touchscreen display visualising all the most frequently used parameters at once by means of function keys, which allow for the running of advanced functions by relieving the operator from complicated mechanical adjustments and considerably speeding up the format changeovers.

In more detail, the following functions are available:

- Label pre-dispensing adjustment
- Adjustment of label dispensing speed
- Labelling delay adjustment in 0.1mm increments
- Storing of 40 different labelling formats
- Automatic recovery of missing labels
- Progressive and regressive pieces counter with automatic stopping device
- Automatic removal of double product detection
- Shift register between product sensor and label positioning point
- End-of-roll alarm and web break alarm
- Output connection to other systems

In addition to its sophisticated standard devices, ALritma can be equipped with an array of ancillary devices:

- Thermal transfer overprinter
- Pneumatic and air-blow applicators
- Checking device for near end-of-reel
- Automatic speed matching via encoder with delay algorithm to maintain label placement position

**Scan here to
get the digital
brochure!**



Technical specifications

	ALRITMA S	ALRITMA M	ALRITMA L
Label width max mm.	100 mm	200 mm	300 mm
Speed	40 mt/min.	40 mt/min.	35 mt/min.
Control	-	Display touch screen	-
Memory capacity	-	40 formats	-
Machine body protection	IP55	IP55	IP55
Unwind unit	300 mm	300 mm	300 mm
Standard alarms	-	web break - drag open	-
Missing labels recovery	S	S	S
Near-end-of-roll check	O	O	O
Pneumatic applicator	O	O	O
Encoder	O	O	O
Transparent label sensors	O	O	O
Coder/TT Printer	O	O	O
AC Power	240V - 50 Hz - 400W	240V - 50 Hz - 500W	240V - 50 Hz - 400W

O = Optional | S = Current | N = Not Available

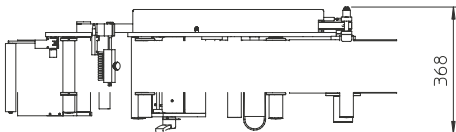
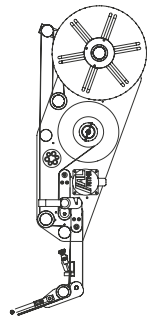
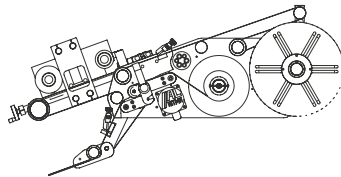
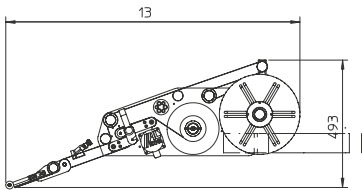

Scan here
to watch
the video!



SELF-ADHESIVE LABEL APPLICATOR ALRITMA XTRA



Alritma X is the new ALTECH model of labelling head, where X emphasises and highlights its exceptional performances of capacity, accuracy, speed and range.

The advanced version of the Alritma X is fitted with an HP (high performance) kit made up of a motorised rewinder unit for the silicon paper as well as an innovative push-pull label web drive system. In this configuration the unit can reach 90 m/min at a cruising rate of 900 labels/min, with high positioning accuracy even when the product transit speed varies.

This version is particularly suited to huge workloads, such as on rotary labellers, especially in applications using printers/markers with their checking devices.

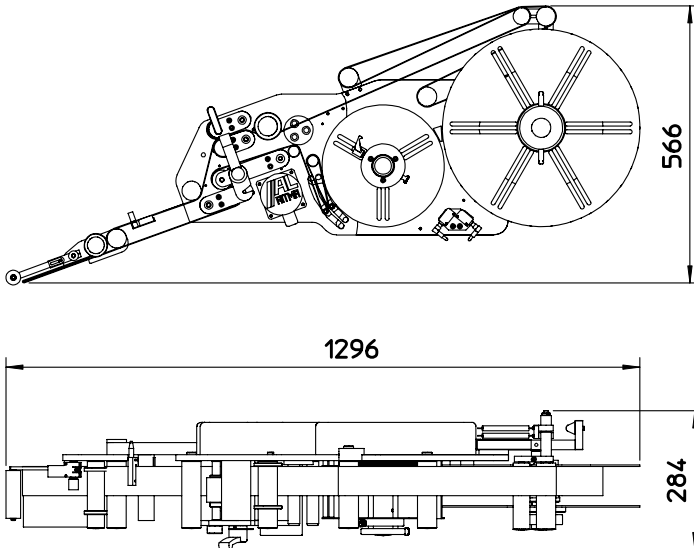

**Scan here to
get the digital
brochure!**



Technical specifications

	ALRITMA X		ALRITMA X HP
Label width max mm.	100 mm (S); 200 mm (M)		100 mm (S); 200 mm (M)
Speed	40 mt/min.		90 mt/min. (70 ver S M)
Controls		Display touch screen	
Memory capacity		40 formats	
Machine body protection		IP55	
Unwind unit	400 mm		400 mm
Rewinder	250 mm		250 mm
Powered rewinder	-		S
Push-pull mechanism	-		S
Standard alarms		end-of-roll - web break - drag open	
Missing labels recovery	S		S
Near-end-of-roll check	O		O
Pneumatic applicator	O		O
Encoder	O		O
Transparent label sensors	O		O
Coder/TT Printer	O		O
AC Power		240V - 50 Hz - 500W	

O = Optional | S = Current | N = Not Available

Scan here
to watch
the video!



LINEAR LABELLING SYSTEMS

ALLINE



The ALLine labelling systems are automatically-operated in line systems which can be configured for the labelling of cylindrical, elliptical or rectangular products; moreover, they can suit specific requirements, such as the application of tamper-proof seals or labelling of singularly shaped products.

In more detail, ALLine is based on the built-in philosophy, which means that all components are included in the structure/cabinet, well protected against dirt and accidental bumps. The cobalt blue (or stainless steel) structure is extremely sturdy and, thanks to its eye-catching design, it qualifies the whole packaging line. The control panel is located in an upper position, well protected against washing liquids or product loss. In standard configurations, the optional safety cabinet perfectly fits into the basic structure, thus sealing the ceiling; its pantograph style doors are extremely ergonomic and considerably reduce the footprint.

The completely internal cable path guarantees simpler cleaning, improved protection as well as a cleaner design. The microprocessor controlled format changeover is coupled with minimum mechanical adjustments, which have been engineered so that every component can be repeatedly positioned in a simple and reliable manner and firmly secured during its operations.

ALLine C

ALLine C is configured to apply wrap-around labels to cylindrical products, usually glass or metal jars and bottles containing foodstuff, as well as chemical, cosmetic and pharmaceutical products in plastic, glass or metal vials. Its compact base may be equipped with a side labelling head of the ALstep or ALritma series.

**Scan here to
get the digital
brochure!**



ALine E

ALine E has been configured to apply two front/back labels to elliptical or rectangular products, generally food, cosmetic, pharmaceutical and chemical products in plastic, glass or metal bottles and jars. Its basement can be fitted with two opposing side Alritma heads. ALine E can be equipped with the handling and spacing devices used on ALine C, whilst specific orienting and stabilising units are also available.

ALine Special

ALine can also be specifically configured to meet special requirements. Multiple labelling in several positions, or the corner application of tamper-proof seals is possible thanks to the integration of extremely reliable and tested modular systems. The labelling of unstable cylindrical products can be performed by means of a special continuous or alternate-motion horizontal rollers conveyor.

Whenever high-speed or range is needed, bigger, powered unwind units can be mounted; for speeds up to 500 p/min, the no-stop configurations, with automatic head activation, allow an easy roll change without having to stop the machine and with no reject for non performed labelling.

Technical specification

- **Power Supply:** 400 V 50 Hz three-phase
- **Power Consumption:** 1 Kw
- **Performances:** up to 500 pcs/min. adjustable

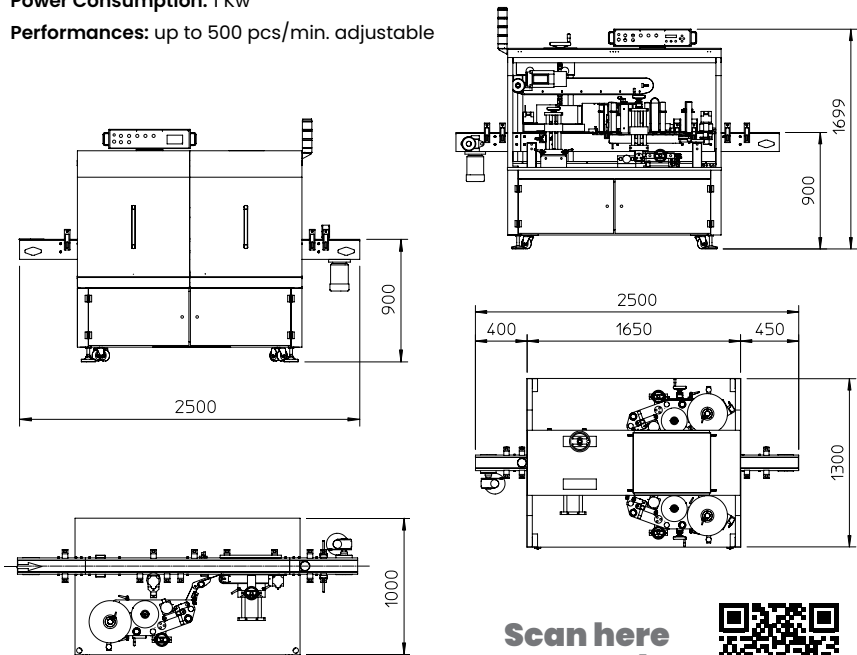

**Scan here
to watch
the video!**



SEMI-AUTOMATIC LABELLER

ALMATIC



ALmatic is a semiautomatic applicator of self-adhesive labels for cylindrical products. Its easy functioning provides for the manual loads of the product in the labelling position by the operator who activates the control lever. So ALmatic provides to the rotation of the product and to the application of the label till a completely happened adhesion.

Thanks to the ergonomics of the system and to the presence of templates of comparison ALmatic allows an exact labelling, making easier the manual operations of the placing of the product. The speed of the label supply, 12 mt/min, allows effecting its application in a very short time.

ALmatic can apply labels till 200 mm width on products with variable diameter from a minimum of 25 mm to a maximum of 110 mm. The format change is made in a fast and intuitive way through some simple sliding levers with block pommels. The industrial structure of the system, characterised from an unwind unit of 280 mm diameter with a tensioning arm, a paper traction group and silicon rewinder, guarantee a big reliability, continuous precision at the beginning and the end of roll and high autonomy.

Technical specification

- **Maximum products diameter:** 110 mm
- **Minimum products diameter:** 25 mm
- **Maximum products height:** 350 mm
- **Maximum labels width:** 200 mm
- **Maximum labels length:** 350 mm
- **Application speed:** 200 mm/sec
- **Labels roll:** 280 mm
- **Power supply:** 230V 50 Hz
- **Option:** hot foil group, transparent label sensor

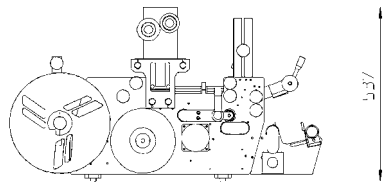
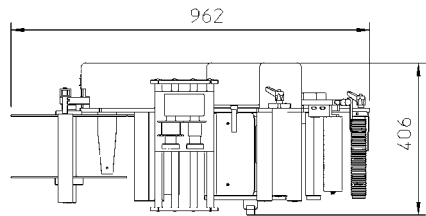

**Scan here to
get the digital
brochure!**



**Scan here
to watch
the video!**



LABELLING SYSTEMS FOR PHARMACEUTICALS

ALPHARMA



The ALpharma self-labelling systems have been specially devised by ALTECH for the packages of pharmaceutical products. Based on the wide experience gained in designing its innovative labelling systems, which have proven extremely successful in all market sectors, ALTECH has developed the ALpharma line, whose particularly advanced features fully comply with the strict rules and regulations of the pharmaceutical industry.

This line has been designed according to the Good Engineering Practices (GEP), with special attention to a range of specific needs, such as:

- Easy cleaning of the machine thanks to its smooth surfaces, the limited amount of interstices, the high position of the electrical parts and/or their protection against liquid spills.
- Ergonomic mechanical parts, easy format change, repeatable settings.
- Noble materials, especially stainless steel (AISI 304 or 316).
- The integration of label printing devices with essential, sensible data (batches, sell-by dates), by means of hot foil or thermal transfer printing units.
- The integration of sensors for correct application, overprinting performed and labelling performed checking.
- The integration of an in-built control system equipped with a Siemens S7-300 PLC and a touchscreen interface which manages all functions of the machine and its checking devices.
- The possibility of certifying the machine as per GAMP 4 (IQ/OQ/PQ) validation process, with the provision of the related documents and the performance of tests (FAT, SAT) according to these procedures.

The ALpharma models are:

- ALpharma A, for labelling vials and small bottles. The labelling is performed from tray to tray, "in the starwheel".
- Up to 150 products/min.
- ALpharma B, for labelling shaped cases, with both bar code labels (tags, vignettes) and tamper evident angle labels folded along the flaps (up to 200 products/min).
- ALpharma C, for inline wrap-around labelling of small, cylindrical bottles.
Up to 250 products/min.

**Scan here
to get the
digital
brochure!**



Options

- Thermal transfer overprinting
- Checking device for near end of reel and rewinder full
- Checking device for near products
- Checking device for bar codes
- Checking device for performed and/or correct overprinting by means of mark readers or a video-camera
- Checking device for performed labelling by means of luminescence sensors or a video camera
- Ejection of non compliant products with checking device for performed ejection and rejects box full
- Management of formats and management of alarms and rejects log

Alpha A

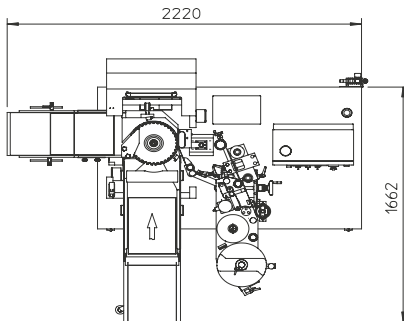
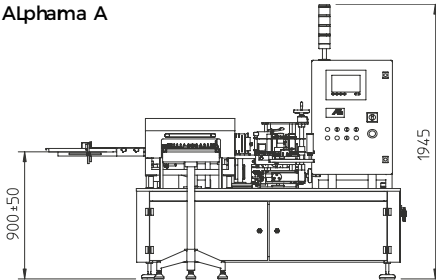

Alpha B

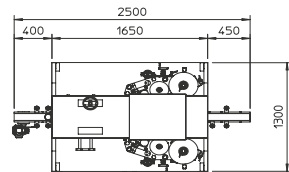
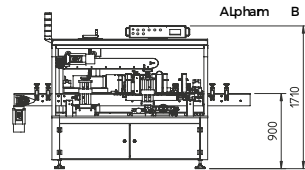

Alpha C

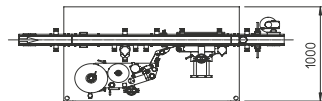
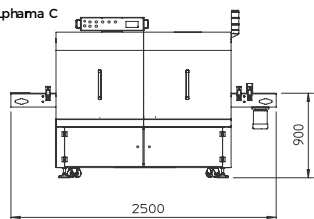

**Scan here
to watch
the video!**



SELF-ADHESIVE LABELLING SYSTEM ACCRAPLY



The incorporation of the very latest in control technology, enables Sirius to handle a wide variety of product and label shapes making it the most versatile, user-friendly, efficient and highly accurate labelling system. Packed with the latest technology for even greater production line benefits. Sirius has been designed to meet the most stringent GMP requirements as well as addressing MTBF (Mean Time Between Failure) and MTRR (Mean Time To Repair) needs.

Enhanced features

- Motion control system provides increased labelling accuracy coupled with absolute speed matching to cope with variable speed demands of today's packaging lines.
- Enhanced control system incorporating single touchscreen user interface provides a very high level of user diagnostics.
- The unique software enables quick set-up times between product changeover and is self-monitoring to provide optimum reliability.
- This reduces the skill level required for operation and maintenance.
- Increased cabinet space allows for greater flexibility for future upgrades.
- Fully integrated inspection systems to identify label and/or overprint presence; barcode readability is available and easily incorporated. Also available is the integration of a vision system capable of identifying label position on the product plus the correct lot/expiration data.
- Modularised transmission system utilising the latest technology ensures that the Sirius provides the optimum level of flexibility and reliability for all current and future labelling requirements.
- These next generation of Harland Sirius features are also incorporated in the Tamper Evident (TE), Twin Side Belt (TSB), Top/Bottom and Vertical Roller Stabiliser (VRS) labellers.

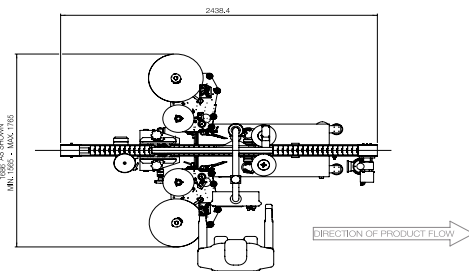

**Scan here
to get the
digital
brochure!**



Technical specifications

- **Base Unit:** Stainless steel unit, available with one or two label stations
- **Infeed Unit:** Single scroll, twin scroll, infeed wheel, orientation units for aligning ovals
- **Label Head:** Label head speed up to 28.5m/min. Stepper motor driven motion controlled
- **Stabiliser:** Horizontally mounted 935mm long servo driven unit
- **Conveyor:** 2438mm long, 82.5mm
- Delryn slatband
- **Finishing Units:** Non-driven and driven wipedown rollers, wrap-around unit, walking beam
- **Overprint Unit:** Hot foil, deboss, thermal transfer, inkjet and laser coders
- **Ancillary Equipment:** A wide range is available including - product and label counters, infeed/outfeed monitoring controls and pharmaceutical security systems
- **Capacities:** As standard
- **Speed:** Up to 300ppm (subject to application)
- **Product:**
 - Max - Minimum Height 350mm - 20mm
 - Max - Minimum Width 200mm - 15mm
 - Max diameter with full wrap-around -100mm
- **Label:**
 - Max - Minimum Web Width 155mm - 13mm
 - Max - Minimum Label Length 330mm - 10mm
 - Max Reel OD 400mm
 - Nominal Reel ID 76mm
- **Electricity Supply:** 220V/240V single phase AC, 50/60Hz. Special electrical options available on request
- **Air Supply:** Air required for some overprinters and security systems
- **Dimensions:** See diagram
- **Weight:** As standard 320kg

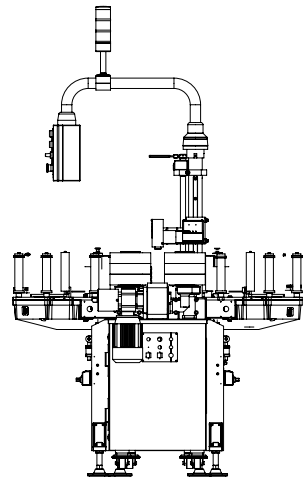

NB: 265mm web width available as an option at extra cost. Increased cabinet space allows for greater flexibility for future upgrades

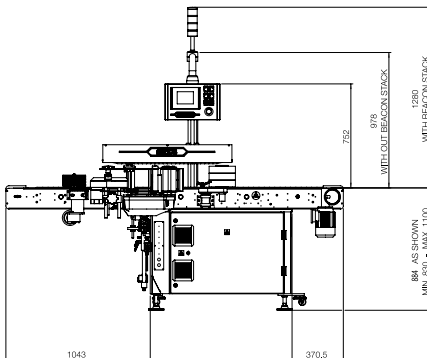

**Scan here
to watch
the video!**



LINEAR HIGH-SPEED LABELLING SYSTEM ACCRAPPLY



The 'Mercury' is the latest development in the Harland Linear Series of labelling systems. The system has been designed for production lines that have a high throughput speed requirement and the need for zero downtime production. This four or two station system can apply front and back labels to any shape of plastic bottle/container at speeds up to 250ppm and fits nicely in the Harland family of labellers, between the wellproven Sirius system and ultra high-speed Titan.

Enhanced features

- Quick and easy changeover between different products is provided by the use of retractable labelling heads that swing out easily when splicing, replenishing or changing label reels; thus minimising line downtime. Further enhanced by colour-coded changeparts.
- Heavy-duty linear modular construction reducing maintenance and changeover costs. Also vital in relation to ease of repairs and servicing. Easily integrated into existing production lines.
- Enhanced control system incorporating single touchscreen user interface provides a very high level of user diagnostics. The unique software enables quick set-up times between product changeover and is self-monitoring to provide optimum reliability and operational efficiency.
- Innovative wipedown module ensures labels are efficiently smoothed to exactly and accurately match the contours of even the most challenging containers and bottles. Optional product handling pucks are available for correctly presenting the most complex of shapes.
- Fully integrated inspection/vision systems provide detection for label verification and presence, accuracy of position and alignment, barcode reading, evaluation and verification.

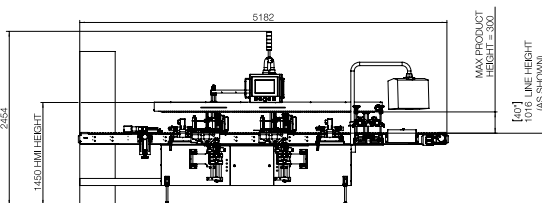

Scan here
to get the
digital
brochure!



Technical specifications

- **Base Unit:** Stainless steel unit, available with two or four label stations
- **Infeed Unit:** Single scroll, twin scroll, infeed wheel, and/or centering units
- **Label Head:** Motion controlled with stepper and servo motor options
- **Stabiliser:** Horizontally mounted servo driven unit
- **Conveyor:** 4500mm-5000mm long, 82.5mm Delryn slatband
- **Finishing Units:** Servo-driven walking beam, powered wipedown rollers
- **Overprint Unit:** Hot foil, deboss, thermal transfer, inkjet and laser coders
- **Ancillary Equipment:** A wide range is available including – product and label counters, infeed/outfeed monitoring controls. Pharmaceutical security system. Integral vision system with single point interface.
- **Capacities:** As standard
- **Speed:** Up to 250ppm (subject to application)
- **Product:**
 - Max – Minimum Height 425mm – 20mm
 - Max – Minimum Width 100mm – 15mm
- **Label:**
 - Max – Minimum Web Width 155mm – 265mm
 - Max – Minimum Label Length 330mm – 10mm
- **Max Reel OD:** 400mm
- **Nominal Reel ID:** 76mm
- **Electrical Supply:** 220/240V Single Phase AC, 50/60Hz subject to validation
- **Weight:** As standard 700kg

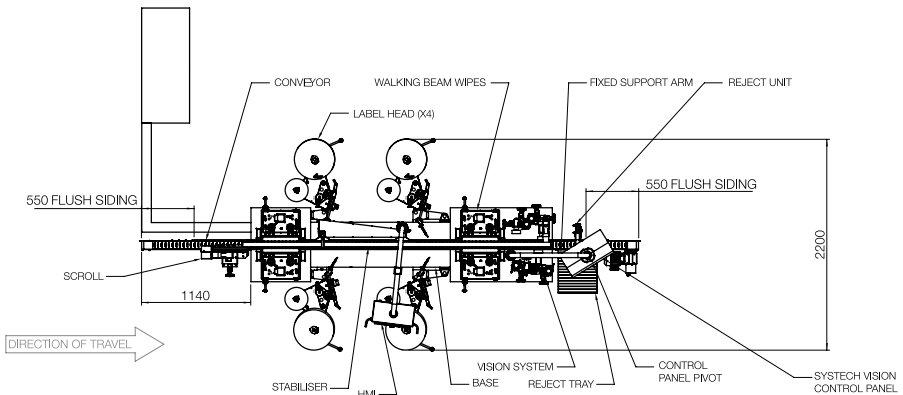

Scan here
to watch
the video!



06

Consumables

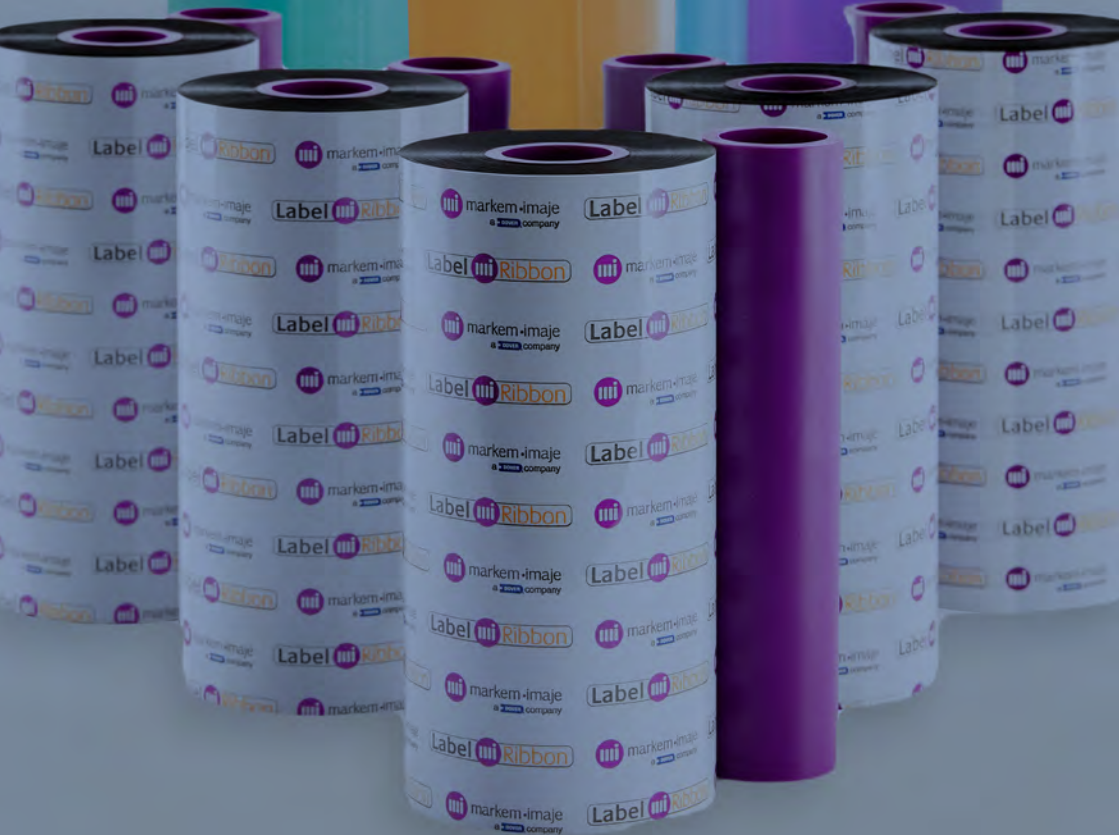

BENEFITS OF CONSUMABLES

Pyrotec PackMark provides a full range of superior consumables based on sound research by chemists based on our principles. These are manufactured specially to work best with the equipment, ensuring durability and long-life.

Benefits of using manufacturer's consumables

EXTENSIVE RANGE

A wide range of consumables is available for marking and coding all types of primary and secondary packaging.

PERFORMANCE AND RELIABILITY

Products have been extensively tested to ensure optimal performance. The entire process, from initial formulation, manufacturing to end sale, is carefully monitored.

FLEXIBILITY

Depending on the application, our principles provide different technologies using different consumables ranging from ketone/alcohol/water-based inks, Touch Dry® Hot Melt inks to thermal transfer ribbons. A wide choice of options, within each technology, exists to allow end-users to meet branding requirements.

REGULATION COMPLIANCE

Genuine consumables provided by our principals comply with industry specific regulations such as food grade, RoHS, Sony Green partner and many others.

EFFICIENCY

On-site application and chemistry support helps you pair the correct consumables with the right printer to meet every application and optimise customer processes.

SAFETY

Every production site is compliant with the best local practices and safety standards. Transportation and manufacturing processes are all ISO 9001 and ISO 14001 certified. Packaging ergonomics have all been designed for enhanced operator safety.

STORAGE

Pyrotec PackMark has hazardous substance warehouses in Cape Town and Johannesburg.



Our Guarantee

Optimal performance and uptime is guaranteed when using our OEM consumables, specifically designed for our equipment.

CONSUMABLES: INKS, RIBBONS, LABELS, DESKTOP PRINTER TTR & COMBO BOX

Pyrotec PackMark offers a comprehensive range of consumables to meet your every printing need. Decades of experience formulating, manufacturing and selling inks ensures that you get the highest quality inks available in the market and optimal performance with our printers.

- Certified as a Sony Green Partner Supplier
- RoHS compliant
- All production sites comply with local regulations, industry standards and best practices
- Proactive monitoring and management of changes to environmental and regulatory issues

Inks for CIJ

- Designed to print on all types of substrates from standard to high performance applications (food grade, sterilisation, UV cure, egg coding, etc.)
- Available in ketone, alcohol, water-based, ketone-free, MEK-free
- Available in a wide variety of colours
- Regulations compliant (RoHS, Sony Green Partner, etc.)

Touch Dry® Hot Melt Inks

- Available for large character and small character inkjet printers
- Touch Dry® technology – solid at room temperature and prints are immediately dry after printing
- Designed to print on a wide range of applications and substrates
- Regulations compliant (RoHS, Sony Green Partner, etc.)

Inks for Secondary Coding

- Designed to print on all types of secondary packaging. Available in alcohol, ethyl acetate and water-based.
- Available in a wide range of colours.
- Regulations compliant (RoHS, Sony Green Partner, etc.)

Thermal Transfer Ribbons for the SmartDate, CimPak, CimJet, 2200 Pallet and 2200 Series

- A wide range of approved high-quality thermal transfer ribbons for both flat and near edge printheads.
- Designed to meet tough and demanding industrial printing applications.
- All ribbons undergo extensive testing to ensure optimal performance with our printers.
- Regulations compliant (RoHS, Sony Green Partner, etc.)

Labels

Pyrotec PackMark supplies labels for its range of Print & Apply labellers. These on specification labels are designed to work perfectly with our thermal transfer ribbon. To make sure your application works correctly, roll sizes are coordinated with ribbon length to maximise uptime during changeover.

Combo Pack of Print & Apply 2200 Series

Pyrotec PackMark can supply labels and TTR (Thermal Transfer Ribbon) to you in a combo pack. The labels and TTR are the same length so that they can be changed at the same time. The combo pack also includes a printhead wipe to clean the printhead at the same time the label and TTR changeover is taking place.



TTR, Labels and Desktop Printer Combo

Pyrotec PackMark can supply blank labels, TTR (Thermal Transfer Ribbon) and TSC desktop printers in one easy combo.

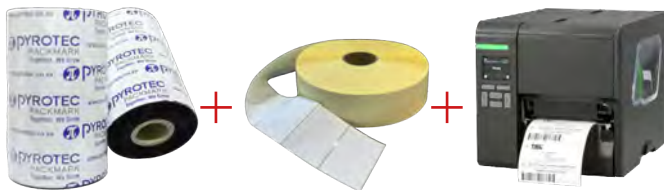

Scan here!



07

Accessories



PYROTEC
WWW.PYROTEC.CO.ZA

ACCESSORIES

Pyrotec PackMark offers a comprehensive range of accessories to meet your printing and labelling needs. Decades of experience ensures that you get the best quality accessories available, ensuring optimal performance for your printers and labellers.

Height adjustment stand

Purpose: Free-standing mount to get machine to height required – fully adjustable.

Mounting brackets

Purpose: Manufactured or modified to suit any application.

Maintenance tray

Purpose: To ensure a clean environment away from production.

Product identification accessories

Sensors/Scanners/Cameras/HMI's

Purpose: Various options to address varying applications:

Industrial Camera's for Factory Automation

Vision Inspection Camera's for Quality control

- Checks the presence/Absence of products/labels
- Pattern Matching
- Detection of defects on products

OCR cameras – Optical Character recognition

- Reads the Human readable text
- Bar code readers

Hand held scanners

Purpose: Hand Held Bar code scanners.

HMI(Human Machine Interface)

Purpose: An HMI is a software application that presents information to an operator or user about the state of a process, and to accept and implement the operators control instructions.

PLC – (Programmable Logic Controller)

Purpose: is a computer used for industrial automation

Encoders

Purpose: It converts information from one format to another to ensure line speed is maintained.

Alarm notification

Purpose: To signal status of operation and notify the operator of faults. Sirens, lights, sensors.

Conveyors

Purpose: Designed to your specifications.



HEIGHT ADJUSTMENT STAND



MOUNTING BRACKETS



MAINTENANCE TRAY



ALARM BEACON



ENCODER



08

Services & Spares

PackMark 24/7

Helpdesk

0800 202 574

Service

In this industry, machine downtime means a waste of valuable time and money. Machine uptime is dependent on quick and efficient installations, superb services and speedy response to breakdowns.

Technical expertise

We have more than 40 years of experience in service and technical expertise needed to successfully install and service its equipment. Our technicians constantly have updated their installation, service and repair skills by experts from our principals.

Accessibility and back-up

The hallmark of our technical support is your accessibility through a toll free technical support helpline (0800 202 574) operational 24/7/365 for all machine technical related queries. The technicians are supported by specially trained product champions based in South Africa which has behind them direct access to Global Indirect Distribution Support (GIDS), based in France, the Netherlands and UK.

Contracts

Short and long term Maintenance Contracts, SLA's (Service Level Agreements) & OSS (Onsite Service Support) are available and are customised to your specific requirements.

Spares

Pyrotec PackMark stocks a comprehensive range of spares in all major centres.

Software

- Pyrotec PackLink software assistance
- CoLOS®v6.xx software assistance



09

PackWorx



CUSTOM ENGINEERING PYROTEC PACKWORX



Pyrotec PackWorx is a general engineering machine shop which includes the development and manufacturing of conveyors, feeding and automated systems for the packaging and manufacturing industry.

Conveyors

- Various types of belts
- Inclines
- Bends
- Flighted
- Variable speed



Scan here!



```
131 }
132 em.mail{
133   background: url(../img/mailico.png) no-repeat center;
134   display: inline-block;
135   width: 12px;
136   height: 14px;
137   float: left;
138   margin: 2px 7px 0 0;
139 }
140 em.phone{
141   background: url(../img/phoneico.png) no-repeat center;
142   display: inline-block;
143   width: 20px;
144   height: 18px;
145   float: left;
146   margin: 3px 8px 0 0;

```

10 Software



CUSTOMISED SOFTWARE SOLUTIONS



PYROTEC PACKLINK

To ensure that every product is assigned to its correct packaging, Pyrotec PackLink's software is a **customisable solution that is fully integrated** with production lines, to provide **Packaging intelligence, track waste, labour, and resources, while increasing line visibility**. The result is improved operational and equipment effectiveness and the ability to expedite critical decisions.

The benefits of Pyrotec PackLink

- 1. Increasing inventory accuracy and forecasting by integrating with
 - ERP - Enterprise Resource Planning Systems
 - MES - Manufacturing Execution Systems
 - WMS - Warehouse Management Systems
- 2. Seamless Data availability at all production locations.
- 3. Production efficiency achieved through, **Product Identification** (Packaging intelligence and quality control with vision inspection), **Track & Trace/Identification** (a combination of RFID/NFC and serialisation).



How Pyrotec PackLink works:

PackLink's customised application integrating/linking hardware/software components. PackLink increases yield and efficiency by identifying defects and flaws in the production line.

PRODUCT INTEGRATION

(Overall Equipment Effectiveness)

PackLink's customised application integrating/linking hardware/software components.



PRODUCT IDENTIFICATION

(Packaging Intelligence and Quality Control)

Vision inspection system ensures the correct product is in the correct packaging. OCR inspection confirms the quality of human readable text.



TRACK & TRACE

(Serialisation and RFID)

PackLink's track & trace application, tracks products with unique serialisation/aggregation QR/Datamatrix codes throughout the production/end user process. PackLink's RFID solution, tracks products through the warehousing/retail process.

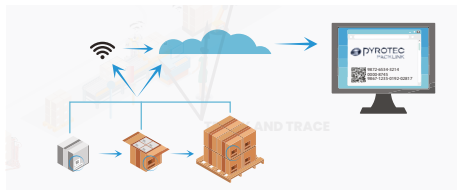

Scan here!



CoLOS®6

NETWORKING SOLUTIONS



SUPPORT ACROSS YOUR PRODUCTION LINE

CoLOS v6.xx is a Markem-Imaje Proprietary networked software that connects together centralized product data, line control systems, operations personnel, networks all Markem-Imaje printers and third party code checking equipment in completely integrated solutions.

Benefits

- You can reduce costs of manual data entry and message data maintenance by 90%.
- You can cut your changeover duration by 50% and save hundreds of hours per year.
- You can ensure that your finished products are correctly marked and 100% compliant with regulations.
- You can reduce your coding errors and cut up to 15% off your total running costs.

Helping you to integrate for the future

CoLOS is a scalable modular solution that reduces waste from coding and marking errors, increases line efficiency and protects brand value by ensuring printing compliance. It does this by facilitating structured message design and data management while streamlining printer set-up during production and providing security and traceability of printed information.

Unlike other suppliers, Markem-Imaje is not reliant on third-party vendors. We make the software and the printers so you will have fewer integration and operational issues than when using a patchwork of products and systems.



Scan here!



11 Finance



Investment Value at Year end

339 970	373 967
56 969	804 029
817	1 296 731
58	1 859 317
6	2 499 808
	3 227 076
	4 050 935
	R 28 331

FINANCING EQUIPMENT



This service by Pyrotec PackMark offers various options to assist customers to purchase or replace their coding and labelling equipment.

Pyrotec Finance offers a rental service where customers rent a unit and return the machine at the end of the contract. Another possibility is financing in the form of a rent-to-own agreement.

- Customers pay a set monthly fee, depending on the rental period, which includes a maintenance contract.
- At the end of the rental period, customers have the choice of paying an additional fee to own the printer or trading it in for a new unit.
- Straightforward trade-in agreements, where customers simply trade in old printers for new units, are also available.

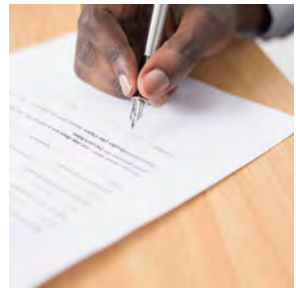
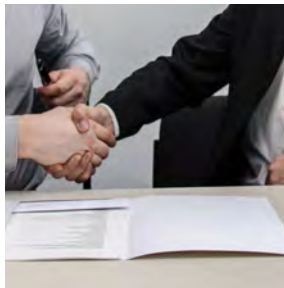

For more information about financing arrangements through Pyrotec Finance, contact us.

Scan here!



A photograph of a laptop keyboard and a smartphone on a wooden desk. The laptop is on the left, and the smartphone is on the right. The text '12 Contact Details' is overlaid in white on the right side of the image. A thin orange horizontal line is positioned below the text.

12 Contact Details

GET IN TOUCH
WE LOVE TO HELP

Cape Town

5 Lakeshore Road, Capricorn Park, Muizenberg 7945
South Africa
Tel +27 (0) 21 787 9600
Fax +27 (0) 21 787 9790/1

Durban

Unit 2, Goodwood Corner, 53 Goodwood Road
Westmead, Pinetown, 3605, South Africa
Tel +27 (0) 31 700 2338

Johannesburg

59 Lepus Road, Crown Ext 8, 2092
South Africa
Tel +27 (0) 11 611 1821
Fax +27 (0) 11 611 1834

Eastern Cape

Room 101, 39 Perkins Street, North End,
Gqeberha 6056, South Africa
Tel +27 (0) 41 487 0601
Service Tel +27 41 487 4059
Fax +27 (0) 41 487 0616

East London

Beacon bay, East London
South Africa
Tel +27 (0) 66 275 6884
ascheepers@pyrotec.co.za



The background of the page shows a modern office interior. On the left, there is a wooden reception desk. Above it, the word "PYROTEC" is written in large, white, 3D block letters. To the right of the desk, a circular logo featuring a stylized Greek letter pi (π) is mounted on a dark wall. The lighting is warm and focused on the desk area.

Namibia

Erf/Plot PTN 58/13,
Otjiwarongo, Namibia
Tel +264 81 128 6757 / +264 81 147 4620
matthiam@tekpaknam.com /
fanie@tekpaknam.com

Zimbabwe

132 Seke Road Corner, Stevenson Road,
Graniteside, Harare, Zimbabwe
Tel +263 77 363 8277 / +263 77 3825480 /
+263 4 751 284

Eswatini

Sisonke Solutions, Plot 784, 1st street Matsapha,
Eswatini
Tel +268 7812 7110
sales@sisonke.com / leroy.healy5@gmail.com

Zambia

11914 Ibex Extension, Mos-Os-Tunya Road,
Lusaka, Zambia
Tel +260 975 740 781
michael@capstonetech.co.zw
capstonezm@gmail.com

Angola

Tel +27 608 0766
spillay@pyrotec.co.za

Pyrotec PackMark is the sole distributor for Markem-Imaje equipment in the following countries: Botswana, Lesotho and Mozambique.

We also distribute ALTECH equipment, Accraply Europe (Harlands) Ltd. and Anser in Mozambique, Botswana, Lesotho, Malawi, Tanzania, Angola, Mauritius and Madagascar.

FOR ENQUIRIES CONTACT US ON:

sales@pyrotec.co.za or packmark@pyrotec.co.za or
tel: +27 (0) 21 787 9600.

PackMark 24/7 Helpdesk 080 020 2574



1000937
36 X 560 ML
OF: 12346423

2200 SYSTEM RIBBON
Batch Number: J-0000000000
05-0000000000



Click icons to go to link:



www.pyrotec.co.za